

# LUDLOW TOWN COUNCIL A G E N D A

## REPRESENTATIONAL COMMITTEE

To: All Members of the Council, Unitary Councillors; Press

**Contact: Gina Wilding, Town Clerk**  
**Ludlow Town Council, The Guildhall**  
**Mill Street, Ludlow, SY8 1AZ**  
01584 871970  
[townclerk@ludlow.gov.uk](mailto:townclerk@ludlow.gov.uk)

**Dispatch date: Thursday 3<sup>rd</sup> April 2025**

You are summoned to attend a meeting of  
Representational Committee at  
The Guildhall, Mill Street, Ludlow SY8 1RZ  
on Tuesday 8<sup>th</sup> April 2025 at 7pm

*Gina Wilding*

Gina Wilding  
Town Clerk

## Key Agenda Items:

- **PLANNING APPLICATIONS**
- **TRAFFIC MANAGEMENT & ROAD CLOSURES**
- **HENLEY ROAD BUS SHELTER**

**Public Open Session (15 minutes in total)** – Members of the public are invited to make representations to the Committee on any matters relating to the work of the Committee. The maximum time allotted per person is three minutes.

**1. HEALTH AND SAFETY**

Councillors and members of the public are to note that the fire exits can be found to the rear of the building and via the front door. The fire assembly point is on the pavement opposite the Guildhall. For fire safety purposes all Councillors should sign the attendance book and members of the public should sign the attendance sheet.

**2. RECORDING OF MEETINGS**

Under the Openness of Local Government Regulations 2014, recording and broadcast including blogging, tweeting and other social media is permitted during public session of Council meetings. The act of recording and broadcasting must not interfere with the meeting.

**3. APOLOGIES**

To receive apologies from committee members.

**4. DECLARATIONS OF INTERESTS**

To receive members' declarations of interests for:

- a) Disclosable Pecuniary Interest
- b) Declaration of conflicts of Interest
- c) Declarations of personal interest

*Members are reminded that they must not participate in the discussion or voting on any matter in which they have a Disclosable Pecuniary Interest and should leave the room prior to the commencement of the debate.*

**5. PUBLIC OPEN SESSION (15 minutes)**

Members of the public are invited to make representations to the Committee on any matters relating to the work of the Committee. The maximum time allotted per person is three minutes. The maximum time for this session if there are multiple speakers is 15 minutes. The public may not speak during the rest of the meeting.

**6. LUDLOW UNITARY COUNCILLORS SESSION**

Ludlow's Unitary Councillors are invited to provide a short update on Shropshire Council matters relating to Ludlow.

**7. MINUTES**

To approve as a correct record and sign the minutes of the Representational Committee meeting held on 11<sup>th</sup> March 2025.

**8. ITEMS TO ACTION**

To note the items to action of the Representational Committee on 11<sup>th</sup> March 2025.

**9. SHROPSHIRE COUNCIL DECISIONS PENDING**

To note the following pending decisions

<b>24/04716/FUL</b>	<b><u>Junction Off A49, Ludlow</u></b> Installation of a new roundabout on the A49 junction North of Ludlow
<b>25/00694/TCA</b>	<b><u>Avalon, St Julians Avenue, Ludlow, SY8 1ET.</u></b> Fell 1no Western Red Cedar within Ludlow (Gravel Hill) Conservation Area

25/00688/TCA	<b><u>Burgess Court , Gravel Hill, Ludlow, SY8 1QW.</u></b> Various works to trees (see attached survey ref: 46 Burgess Court) within Ludlow (Gravel Hill) Conservation Area
25/00687/FUL	<b><u>2 Linney Fields , Linney, Ludlow, SY8 1EE.</u></b> Erection of two storey extension to rear elevation
25/00347/FUL	<b><u>Proposed Dwelling To The North Of, Steventon New Road, Ludlow.</u></b> Erection of dwelling
25/00573/FUL	<b><u>Proposed Residential Development Site, Steventon New Road, Ludlow</u></b> Erection of open-market dwelling
25/00719/LBC	<b><u>22 Old Street, Ludlow, SY8 1NP</u></b> Replace existing kitchen sash window with a smaller size sash window

## 10. SHROPSHIRE COUNCIL DECISIONS

To note the following decisions.

25/00369/FUL	<b><u>The Orchard , Linney, Ludlow, SY8 1EE</u></b> Demolition/removal of existing lean-to external structures, erection of outbuilding/workshop, car port, rationalisation of entrance sequence and entrance court parking	<b>GRANTED</b>
25/00209/FUL	<b><u>Brechans , Camp Lane, Ludlow, SY8 1EQ</u></b> Alterations and additions	<b>GRANTED</b>
24/04832/FUL	<b><u>37 Lower Broad Street, Ludlow, SY8 1PH</u></b> Erection of single storey extension (following demolition), replacement of windows, new/replacement rooflights, new external doorway, replacement render (if req.), formation of hardstanding (patio) to rear and internal alterations	<b>GRANTED</b>
24/04833/LBC	<b><u>37 Lower Broad Street, Ludlow, SY8 1PH</u></b> Works to facilitate the erection of single storey rear extension (following demolition), insertion of new/replacement windows/doors/rooflights, replacement render (if req.), internal works to include removal of partitions, creation of hardstanding (patio area)	<b>GRANTED</b>
25/00309/FUL	<b><u>Biodigester Station, Coder Road, Ludlow, SY8 1XE</u></b> Change of Use of a Biowaste Digester to recycle household organic waste building to a Biochar Production Facility, erection of extension and installation of associated infrastructure (sui generis)	<b>GRANTED</b>
25/00443/LBC	<b><u>Riverside , 18 Temeside, Ludlow, SY8 1PD</u></b> Replacement of existing rear garage upvc windows with new Crittal style metal window and provision of wood burning stove / twin walled stainless steel external flue	<b>GRANTED</b>

## 11. PLANNING APPLICATIONS

To consider and comment on all validated planning applications.

For full details of validated applications, please follow the link below and search Ludlow Town Council <https://pa.shropshire.gov.uk/online-applications/search.do?action=weeklyList&searchType=Application>

25/00860/TCA	<p><b><u>St Leonards Churchyard , Corve Street, Ludlow, SY8 1DL</u></b>          Proposal: Remove limb from 1no. Cypress (T1) and crown lift 3no. Yews (T3 and T4) (as per schedule) within Ludlow Conservation Area  <a href="http://pa.shropshire.gov.uk/online-applications/applicationDetails.do?activeTab=summary&amp;keyVal=SSM4ZWTDGAT00">http://pa.shropshire.gov.uk/online-applications/applicationDetails.do?activeTab=summary&amp;keyVal=SSM4ZWTDGAT00</a></p>
25/00991/TCA	<p><b><u>19 Broad Street, Ludlow, SY8 1NG</u></b>          Fell 1no Katsura tree and replant with a native species within Ludlow Conservation Area  <a href="http://pa.shropshire.gov.uk/online-applications/applicationDetails.do?activeTab=summary&amp;keyVal=ST45W4TD0GI00">http://pa.shropshire.gov.uk/online-applications/applicationDetails.do?activeTab=summary&amp;keyVal=ST45W4TD0GI00</a></p>
25/00554/FUL	<p><b><u>New Prospect , Julian Road, Ludlow, SY8 1HD.</u></b>          Replace garage door with bay window, erection of brick piered fence within garden boundary, garden shed, change windows into french doors (north/south elevations)  <a href="http://pa.shropshire.gov.uk/online-applications/applicationDetails.do?activeTab=summary&amp;keyVal=SRL3T2TDFT300">http://pa.shropshire.gov.uk/online-applications/applicationDetails.do?activeTab=summary&amp;keyVal=SRL3T2TDFT300</a></p>
25/01010/TCA	<p><b><u>The Bridge Inn , Corve Street, Ludlow, SY8 1DX</u></b>          Crown reduce by up to 50% 1no. Sycamore (T1) within Ludlow Conservation Area  <a href="http://pa.shropshire.gov.uk/online-applications/applicationDetails.do?activeTab=summary&amp;keyVal=ST4QNOTDGJ700">http://pa.shropshire.gov.uk/online-applications/applicationDetails.do?activeTab=summary&amp;keyVal=ST4QNOTDGJ700</a></p>
25/00878/FUL	<p><b><u>4 Brand Lane, Ludlow, SY8 1NN</u></b>          Fenestration alterations, ground level reduction to rear garden area and installation of york stone hard surfacing  <a href="http://pa.shropshire.gov.uk/online-applications/applicationDetails.do?activeTab=summary&amp;keyVal=SSNZTQTDGBO00">http://pa.shropshire.gov.uk/online-applications/applicationDetails.do?activeTab=summary&amp;keyVal=SSNZTQTDGBO00</a></p>
25/00879/LBC	<p><b><u>4 Brand Lane, Ludlow, SY8 1NN</u></b>          Rear fenestration and doors alterations, ground level reduction to rear garden area and installation of york stone hard surfacing, internal layout alterations including removal of the existing brick fireplace and installation of a new stove and surround to the dining room, removal of partition walls and ceiling adjustments including installation of roof insulation  <a href="http://pa.shropshire.gov.uk/online-applications/applicationDetails.do?activeTab=summary&amp;keyVal=SSNZTRTDGBP00">http://pa.shropshire.gov.uk/online-applications/applicationDetails.do?activeTab=summary&amp;keyVal=SSNZTRTDGBP00</a></p>
25/00884/LBC	<p><b><u>Feathers Hotel , Bull Ring, Ludlow, SY8 1AA.</u></b>          Installation of additional fire compartmentalisation into the existing building  <a href="http://pa.shropshire.gov.uk/online-applications/applicationDetails.do?activeTab=summary&amp;keyVal=SSNZYMTDGC000">http://pa.shropshire.gov.uk/online-applications/applicationDetails.do?activeTab=summary&amp;keyVal=SSNZYMTDGC000</a></p>
25/01054/TPO	<p><b><u>39 The Cliff Park , Halton Lane, Ludlow, SY8 2JF.</u></b>          Reduce elongated southern limbs by 1.5m of 1no. Douglas Fir (T25) protected by The Council of the South Shropshire District Council (Cliffe Caravan Park, Dinham, Ludlow) TPO 2001 (SS/00058/01)</p>

	<a href="http://pa.shropshire.gov.uk/online-applications/applicationDetails.do?activeTab=summary&amp;keyVal=STA7W6TDGLQ00">http://pa.shropshire.gov.uk/online-applications/applicationDetails.do?activeTab=summary&amp;keyVal=STA7W6TDGLQ00</a>
<b>25/00966/FUL</b>	<b>Spencer Manufacturing Co Ltd, Orleton Road, Ludlow, SY8 1XF.</b> Proposed mixed use of Spencer Manufacturing unit as storage and distribution, retail, offices and complementary uses by St Michael's Hospice (Class B8 and E) <a href="http://pa.shropshire.gov.uk/online-applications/applicationDetails.do?activeTab=summary&amp;keyVal=ST0YAGTDGH100">http://pa.shropshire.gov.uk/online-applications/applicationDetails.do?activeTab=summary&amp;keyVal=ST0YAGTDGH100</a>
<b>25/00934/LBC</b>	<b>Lloyds Bank Plc, Bank House, 16 Broad Street, Ludlow,</b> Proposed ATM and signage removal on a listed building <a href="http://pa.shropshire.gov.uk/online-applications/applicationDetails.do?activeTab=summary&amp;keyVal=SSX928TDGF400">http://pa.shropshire.gov.uk/online-applications/applicationDetails.do?activeTab=summary&amp;keyVal=SSX928TDGF400</a>
<b>25/01015/LBC</b>	<b>Lloyds Bank Plc, Bank House, 16 Broad Street, Ludlow,</b> Internal door repairs/upgrades with certain doors replaced with new designs <a href="http://pa.shropshire.gov.uk/online-applications/applicationDetails.do?activeTab=summary&amp;keyVal=ST4OQ3TDGJH00">http://pa.shropshire.gov.uk/online-applications/applicationDetails.do?activeTab=summary&amp;keyVal=ST4OQ3TDGJH00</a>
<b>25/01074/FUL</b>	<b>Holdgate , St Johns Lane, Ludlow, SY8 1PF</b> New dormer and rooflight, chimney alterations and amendment of ground floor window to a door <a href="http://pa.shropshire.gov.uk/online-applications/applicationDetails.do?activeTab=summary&amp;keyVal=STC2BLTDGMT00">http://pa.shropshire.gov.uk/online-applications/applicationDetails.do?activeTab=summary&amp;keyVal=STC2BLTDGMT00</a>
<b>25/01241/TCA</b>	<b>Stanton House, 41 Gravel Hill, Ludlow, SY8 1QR</b> Pollard to previous points at 1.5m 2no Sycamores within Ludlow (Gravel Hill) Conservation Area <a href="http://pa.shropshire.gov.uk/online-applications/applicationDetails.do?activeTab=summary&amp;keyVal=STTW HITDOGI00">http://pa.shropshire.gov.uk/online-applications/applicationDetails.do?activeTab=summary&amp;keyVal=STTW HITDOGI00</a>

## 12. ROAD CLOSURE/TRAFFIC MANAGEMENT

To consider the road closures and traffic management listed below and online.

Road closures can be viewed at: <https://roadworks.org/> or <https://one.network/>

Date	Location	Traffic Management	Company	Work Description
11 <sup>th</sup> April 2025 - 12 <sup>th</sup> April 2025 Friday 19:00 Saturday 06:00	Bullring Ludlow	Road Closure-	Severn Trent Water	CARRIAGEWAY TYPE 1 (10 TO 30 MSA) * SV Rebuild chamber x5- Works are agreed to take place Friday evening after 19:00 and will be cleared by 06:00am Saturday morning. This is due to STW requiring access to the valves as there is high indication of leakage round the town and is becoming a risk that if this

				continues to get worse it could leak to pressure and supply issues for customers. The issue currently is that the valves are not accessible and require the chambers reconstructing in order for them to access these.
22 <sup>nd</sup> April 9.30 -15.30	Old Street	Traffic signals	Open Reach	Utility Asset Works. Pavement will be accessible

**13. BUILDINGS, BUILDING LAND AND TREES**

To consider recent updates and / or provide information.

**14. PAVEMENT LICENCE CONSULTATION - HARP LANE DELI.**

To consider the pavement licence application: [Pavement Licence Consultation - Harp Lane Deli](#)

**15. PAVEMENT LICENCE CONSULTATION – THE WHEATSHEAF**

To consider the pavement licence application: [Pavement licence consultation - The Wheatsheaf Inn, Ludlow](#)

**16. NOTICE AND PROVISIONAL ORDER FOR THE SHROPSHIRE COUNCIL (LAND OFF ST JOHN'S LANE AND OLD STREET, LUDLOW) TPO 2025 (REF: SC/00533/25)**

To consider the notice and provisional order.

**17. PLANNING AND INFRASTRUCTURE BILL INTRODUCED TO PARLIAMENT**

To note

**18. EXCLUSION OF PRESS AND PUBLIC: PUBLIC BODIES (ADMISSION TO MEETINGS) ACT 1960**

The Chair will move that the public be excluded from the meeting for the following item(s) of business pursuant to section 1 of the Public Bodies (Admission to Meetings) Act 1960, on the grounds that publicity would be prejudicial to the public interest by reason of the confidential nature of the business to be transacted.

**19. HENLEY ROAD BUS SHELTER**

To accept the offer to refurb the Henley Road bus shelter as per the report.

**Membership**

Councillors Gill, Ginger (Chairman), Hall, Harris, Jones, Parry, Tapley, Thompson, B. Waite, S.Waite (Vice)

The next meeting of members of Representational Committee will be held on Tuesday 20<sup>th</sup> May 2025

**Item 7**

**MINUTES**

## MINUTES

Minutes of a meeting of the **REPRESENTATIONAL COMMITTEE** held at the Guildhall Mill Street Ludlow on **TUESDAY 11<sup>th</sup> March 2025 at 7pm.**

### **R/278 PRESENT**

Chair: Councillor G Ginger

Councillors: Councillors Gill, Hall, Harris (19:04), Jones, Parry, Tapley, B Waite, S Waite

Officers: Gina Wilding, Town Clerk  
Charlotte Ambrazas Committee Officer

### **R/279 ABSENCES**

Councillor Thompson was absent.

### **R/280 HEALTH AND SAFETY**

The Chairman informed Councillors, and everyone present, of the fire exits, fire assembly point and asked that everyone sign the attendance log.

### **R/281 RECORDING OF MEETINGS**

The Chairman notified those present that under the Openness of Local Government Regulations 2014, recording and broadcasting is permitted during public session of Council Meetings.

### **R/282 APOLOGIES**

Apologies were received from Councillor Thompson (family funeral)

### **R/283 DECLARATIONS OF INTEREST**

Disclosable Pecuniary Interests

None

Conflicts of Interest

None

Personal Interest

Cllr Parry	25/00443/LBC	Knows the applicant
------------	--------------	---------------------



Cllr S Waite	25/00719/LBC	Knows the applicant
--------------	--------------	---------------------

**R/284 PUBLIC OPEN SESSION (15 minutes)**

There were no public present.

**R/285 LUDLOW'S UNITARY COUNCILLORS QUESTION AND ANSWER SESSION**

No updates were available.

**R/286 MINUTES****RESOLVED GG/SW (unanimous)**

To approve the minutes of 11<sup>th</sup> March 2025 as a correct record for the Chairman to sign.

**R/287 ITEMS TO ACTION****RESOLVED GG/BW (unanimous)**

To note the items to action of 11<sup>th</sup> March 2025

7.04pm Cllr Harris joined the meeting

**R/288 SHROPSHIRE COUNCIL DECISIONS PENDING****RESOLVED GG/TG (unanimous)**

That the decisions pending by Shropshire Council be noted

**R/289 SHROPSHIRE COUNCIL DECISIONS****RESOLVED GG/TG (unanimous)**

That the decisions by Shropshire Council be noted

**R/290 PLANNING APPLICATIONS****24/04716/FUL Junction Off A49, Ludlow****RESOLVED GG/TG (unanimous)**

No Objection to the installation of a new roundabout.

**R/291 25/00443/LBC Riverside , 18 Temeside, Ludlow, SY8 1PD**

**RESOLVED GG/TG (8:0:1)**

No objection to the replacement of existing rear garage upvc windows with new Crittal style metal window and provision of wood burning stove / twin walled stainless steel external flue

**R/292 25/00694/TCA Avalon, St Julians Avenue, Ludlow, SY8 1ET.**

**RESOLVED GG/SW (6:0:3)**

No Objection to fell 1no Western Red Cedar within Ludlow (Gravel Hill) Conservation Area.

**R/293 25/00688/TCA Burgess Court , Gravel Hill, Ludlow, SY8 1QW.**

**RESOLVED GG/SW (7:0:2)**

No Objection to various works to trees (see attached survey ref: 46 Burgess Court) within Ludlow (Gravel Hill) Conservation Area.

**R/294 25/00687/FUL 2 Linney Fields , Linney, Ludlow, SY8 1EE.**

**RESOLVED GG/RH (8:0:1)**

No Objection to the erection of two storey extension to rear elevation

**R/295 25/00347/FUL Proposed Dwelling To The North Of, Steventon New Road, Ludlow,**

**RESOLVED GG/SH (unanimous)**

To Object to the erection of dwelling for the following reasons:

- i) The development overlooks other houses and is overbearing and out of keeping with the existing street scene
- ii) It is too large for the site
- iii) The development adds extra vehicular traffic to a shared narrow entrance / egress
- iv) The dwelling would create light pollution and disruption to wildlife including bats because it impinges on the otherwise dark corridor created by the railway line.
- v) There is a statement that the development is exempt from biodiversity net gain, but this is not adequately explained.

**R/296**      **25/00573/FUL Proposed Residential Development Site, Steventon  
New Road, Ludlow**

**RESOLVED GG/RH (6:2:1)**

No objection to erection of open-market dwelling.

**R/297**      **25/00719/LBC 22 Old Street, Ludlow, SY8 1NP**

**RESOLVED GG/RJ (unanimous)**

No Objection to replace existing kitchen sash window with a smaller size sash window

**R/298**      **ROAD CLOSURE/ TRAFFIC MANAGEMENT**

**RESOLVED    GG/SH (unanimous)**

The road closures and traffic management were noted.

**R/299**      **BUILDINGS, BUILDING LAND AND TREES**

**RESOLVED    GG/TG (unanimous)**

To update the spreadsheet with the following:

- i)      Request an update from SC regarding on the historic well and Horse Chestnut tree on Livsey Road.
- ii)     To insert the update from SC council regarding the TPO requests including the Black Walnut tree, and further to this update the tree officer that the committee consider the TPO to be an urgent matter that should be actioned as soon as possible.
- iii)    To record the status of the application (believed to be refused) on the Land to the north of Menai Foam and Board site.

**R/300**      **THE PEACE MEMORIAL HOLLY TREE**

**RESOLVED    GG/RJ (unanimous)**

To note that the essential tree works will be undertaken with permission from Shropshire Council.

**R/301     GOVERNMENT GUIDANCE ON GREEN BELT**

**RESOLVED   GG/RH (unanimous)**

That the guidance be noted

**R/302     EXCLUSION OF PRESS AND PUBLIC: PUBLIC BODIES (ADMISSION TO MEETINGS) ACT 1960**

**RESOLVED   GG/BW (unanimous)**

That the public be excluded from the meeting for the following item(s) of business pursuant to section 1 of the Public Bodies (Admission to Meetings) Act 1960, on the grounds that publicity would be prejudicial to the public interest by reason of the confidential nature of the business to be transacted

Meeting closed at 7:49 pm

\_\_\_\_\_  
Chairman

\_\_\_\_\_  
Date

Closed Session minutes will be issued.

**ITEMS TO ACTION**

**Representational Committee**  
**ITEMS TO ACTION**

**11.02.2025**

<b>REP meeting</b> <b>11.03.2025</b>	<b><u>ITEM</u></b>	<b><u>ACTION</u></b>		<b><u>DATE</u></b>	<b><u>STATUS</u></b>
REP/25/290	<p><b><u>PLANNING APPLICATIONS</u></b></p> <p><b><u>24/04716/FUL Junction Off A49, Ludlow</u></b></p> <p><b><u>RESOLVED GG/TG (unanimous)</u></b> No Objection to the installation of a new roundabout.</p>	Comments submitted to Shropshire Council	CA	12/03/2025	Completed
REP/25/291	<p><b><u>25/00443/LBC Riverside , 18 Temeside, Ludlow, SY8 1PD</u></b></p> <p><b><u>RESOLVED GG/TG (8:0:1)</u></b> No objection to the replacement of existing rear garage upvc windows with new Crittal style metal window and provision of wood burning stove / twin walled stainless steel external flue</p>	Comments submitted to Shropshire Council	CA	12/03/2025	Completed
REP/25/292	<p><b><u>25/00694/TCA Avalon, St Julians Avenue, Ludlow, SY8 1ET.</u></b></p> <p><b><u>RESOLVED GG/SW (6:0:3)</u></b> No Objection to fell 1no Western Red Cedar within Ludlow (Gravel Hill) Conservation Area.</p>	Comments submitted to Shropshire Council	CA	12/03/2025	Completed
REP/25/293	<p><b><u>25/00688/TCA Burgess Court , Gravel Hill, Ludlow, SY8 1QW.</u></b></p> <p><b><u>RESOLVED GG/SW (7:0:2)</u></b> No Objection to various works to trees (see attached survey ref: 46 Burgess Court) within Ludlow (Gravel Hill) Conservation Area.</p>	Comments submitted to Shropshire Council	CA	12/03/2025	Completed
REP/25/294	<p><b><u>25/00687/FUL 2 Linney Fields , Linney, Ludlow, SY8 1EE.</u></b></p> <p><b><u>RESOLVED GG/RH (8:0:1)</u></b> No Objection to the erection of two storey extension to rear elevation</p>	Comments submitted to Shropshire Council	CA	12/03/2025	Completed
REP/25/295	<p><b><u>25/00347/FUL Proposed Dwelling To The North Of, Steventon New Road, Ludlow,</u></b></p>	Comments submitted to	CA	13/03/2025	Completed

**Representational Committee**  
**ITEMS TO ACTION**

**11.02.2025**

	<p><b><u>RESOLVED GG/SH (unanimous)</u></b>          To Object to the erection of dwelling for the following reasons:          i) The development overlooks other houses and is overbearing and out of keeping with the existing street scene          ii) It is too large for the site          iii) The development adds extra vehicular traffic to a shared narrow entrance / egress          iv) The dwelling would create light pollution and disruption to wildlife including bats because it impinges on the otherwise dark corridor created by the railway line.          v) There is a statement that the development is exempt from biodiversity net gain, but this is not adequately explained.</p>	Shropshire Council			
REP/25/296	<p><b><u>25/00573/FUL Proposed Residential Development Site, Steventon New Road, Ludlow</u></b>   <b><u>RESOLVED GG/RH (6:2:1)</u></b>          No objection to erection of open-market dwelling.</p>	Comments submitted to Shropshire Council	CA	12/03/2025	Completed
REP/25/297	<p><b><u>25/00719/LBC 22 Old Street, Ludlow, SY8 1NP</u></b>   <b><u>RESOLVED GG/RJ (unanimous)</u></b>          No Objection to replace existing kitchen sash window with a smaller size sash window</p>	Comments submitted to Shropshire Council	CA	12/03/2025	Completed
REP/25/299	<p><b><u>BUILDINGS, BUILDING LAND AND TREES</u></b>   <b><u>RESOLVED GG/TG (unanimous)</u></b>          To update the spreadsheet with the following:          i) Request an update from SC regarding on the historic well and Horse Chestnut tree on Livsey Road.          ii) To insert the update from SC council regarding the TPO requests including the Black Walnut tree, and further to this update the tree officer that the committee consider the TPO to be an urgent matter that should be actioned as soon as possible.          iii) To record the status of the application (believed to be refused) on the Land to the north of Menai Foam and</p>	Write to Shropshire Council	GW	12/03/2025	Ongoing

**Representational Committee**  
**ITEMS TO ACTION**

**11.02.2025**

	Board site.				
REP/25/300	<p><b><u>THE PEACE MEMORIAL HOLLY TREE</u></b></p> <p><b><u>RESOLVED</u></b> GG/RJ (unanimous)          To note that the essential tree works will be undertaken with permission from Shropshire Council.</p>	Noted		12/03/2025	Completed
REP/25/301	<p><b><u>GOVERNMENT GUIDANCE ON GREEN BELT</u></b></p> <p><b><u>RESOLVED</u></b> GG/RH (unanimous)          That the guidance be noted</p>	Noted		12/03/2025	Completed
REP/25/303	<p><b><u>REFURBISHMENT OF MILL STREET BUS SHELTER</u></b></p> <p><b><u>RESOLVED</u></b> GG/BW (unanimous)</p> <p>i) That the quotation provided by GW Shelter for the refurbishment of Mill Street bus shelter be accepted, subject to the paint colour being approved by the Conservation Officer.</p> <p>ii) To approve obtaining quotations for the refurbishment of the Henley Road bus shelter to be brought to the Representational Committee in April for consideration.</p>				
REP meeting 11.02.2025	<b><u>ITEM</u></b>	<b><u>ACTION</u></b>		<b><u>DATE</u></b>	<b><u>STATUS</u></b>
REP/25/266	<p><b><u>PLANNING APPLICATIONS</u></b>  <b><u>25/00089/FUL Proposed Dwelling North Of 18, Stanton Road, Ludlow</u></b></p> <p><b><u>NOT CARRIED</u></b> GG/VP (2:4:2)  <i>To object because the proposed development is over development of the site.</i></p> <p><b><u>RESOLVED</u></b> TG/SH (3:2:3)          No objection to the erection of dwelling.</p>	Comments submitted to Shropshire Council	CA	12/02/2025	Completed
REP/25/267	<p><b><u>24/04832/FUL 37 Lower Broad Street, Ludlow, SY8 1PH</u></b></p>	Comments submitted to Shropshire	CA	12/02/2025	Completed



**Representational Committee**  
**ITEMS TO ACTION**

**11.02.2025**

	<p><b><u>RESOLVED GG/DT (8:1:0)</u></b>          No objection to the erection of single storey extension (following demolition), replacement of windows, new/replacement rooflights, new external doorway, replacement render (if req.), formation of hardstanding (patio) to rear and internal alterations</p>	Council			
REP/25/268	<p><b><u>24/04833/LBC 37 Lower Broad Street, Ludlow, SY8 1PH</u></b></p> <p><b><u>RESOLVED GG/DT (8:1:0)</u></b>          No Objection to works to facilitate the erection of single storey rear extension (following demolition), insertion of replacement windows, new/replacement rooflights, new external doorway, replacement render (if req.), internal works to include removal of partitions, creation of hardstanding (patio area).</p>	Comments submitted to Shropshire Council	CA	12/02/2025	Completed
REP/25/269	<p><b><u>25/00209/FUL Brechans , Camp Lane, Ludlow, SY8 1EQ</u></b></p> <p><b><u>RESOLVED GG/DT (unanimous)</u></b>          No Objection to alterations and additions</p>	Comments submitted to Shropshire Council	CA	12/02/2025	Completed
REP/25/270	<p><b><u>25/00309/FUL Biodigester Station, Coder Road, Ludlow,SY8 1XE.</u></b></p> <p><b><u>RESOLVED GG/BW (unanimous)</u></b>          To Object for the following reasons relating to harmful environmental impacts, specifically:          i)The study supplied in the application used virgin feedstock, so the application does not adequately consider the environmental implications to using food garden waste derived feedstock mentioned in the application.          ii) The studies regarding the impact to wildlife are not conclusive or adequately rigorous.          iii) The application has not adequately considered the impact of increased traffic related to the operation of the site on Parrys Road.</p>	Comments submitted to Shropshire Council	CA	13/02/2025	Completed

**Representational Committee**  
**ITEMS TO ACTION**

**11.02.2025**

	<p>iv) The application indicates that the sulphur dioxide levels are expected to remain within permitted limits, but the concentrations mentioned could create unpleasant smells.</p> <p>v) The application has not adequately considered the site's impact of the ground water in relation to the effects / risks of contamination of the three SSSI sites locally.</p>				
<b>REP/25/271</b>	<p><b><u>25/00369/FUL The Orchard , Linney, Ludlow, SY8 1EE.</u></b></p> <p><b><u>RESOLVED GG/DT (unanimous)</u></b>          No Objection to the demolition/removal of existing lean-to external structures, erection of outbuilding/workshop, car port, rationalisation of entrance sequence and entrance court parking</p>	Comments submitted to Shropshire Council	CA	12/02/2025	<b>Completed</b>
<b>REP/25/273</b>	<p><b><u>BUILDINGS, BUILDING LAND AND TREES</u></b></p> <p><b><u>RESOLVED GG/RH (unanimous)</u></b>          To note the spreadsheet information.</p> <p>To report to Shropshire Council and monitor through inclusion to the spreadsheet.</p> <p>i) Friars Walk behind Busy Bodies Nursery trees have been cut and there are loose high level branches left on site, which could dislodge and cause harm, and smaller cuttings have been left on the ground and could become trip hazards.</p> <p>ii) Parys Road, from Dark Lane to Bowdler, an overgrown hedge encroaching on the public footpath.</p> <p>iii) Dark Lane is overgrown and needs clearing of leaves and debris.</p> <p>iv) Castle Street car park - tree roots in the centre of the carpark have ruptured the tarmac causing a trip hazard.</p> <p>v) Galdeford carpark opposite Station Drive</p>	Write to Shropshire Council	CA	13/02/2025	<b>Ongoing</b>

**ITEMS TO ACTION**

	<p>Surgery hedge overgrown and forcing people into the road.</p> <p>vi) Write to Shropshire Council to ensure there is a TPO on the Walnut tree at St Johns and confirm if there was a TPO / and felling application process for the Sycamore tree (felled) on the corner of Temeside &amp; Old Street.</p>				
<b>REP/25/275</b>	<p><b><u>PLANNING ENFORCEMENT</u></b></p> <p><b><u>RESOLVED GG/TG (unanimous)</u></b></p> <p>To seek confirmation from Shropshire Council and voice concerns regarding Ludlow Express Convenience Store, 8 King Street, Ludlow.</p> <ul style="list-style-type: none"> <li>• To report the lack of FUL / LBC / ADV/ COU applications, or approvals including external advertising not suitable for a conservation area, extensive opening times, and residential use of the upper floors to planning and building control.</li> <li>• To report suspected underage sales of tobacco / vapes; and sales of illegal vapes to trading standards / public protection.</li> <li>• To query the premises status regarding alcohol sales.</li> <li>• To query the premises status regarding environmental health related to food</li> </ul>	Write to Shropshire Council	CA	13/02/2025	Ongoing
<b>REP/25/276</b>	<p><b><u>DOG FOULING</u></b></p> <p><b><u>RESOLVED GG/TG (unanimous)</u></b></p> <p>To write to Shropshire Council</p> <p>i) To ask Shropshire Council to enforce fines for dog fouling</p> <p>ii) To approve increased use of Ludlow Town Council social media and website to help people report dog fouling to Shropshire Council.</p>	Write to Shropshire Council	GW		Ongoing

**Representational Committee**  
**ITEMS TO ACTION**

**11.02.2025**

<b>REP meeting 14.01.2025</b>	<b><u>ITEM</u></b>	<b><u>ACTION</u></b>		<b><u>DATE</u></b>	<b><u>STATUS</u></b>
REP/25/242	<b><u>24/04726/FUL Tresco Veau , Burway Lane, Ludlow, SY8 1DT</u></b>  <b><u>RESOLVED GG/RH (unanimous)</u></b> No Objection to erection of extensions and alteration.	Submit comments to Shropshire Council	CA	15/01/2025	Completed
REP/25/243	<b><u>24/04743/FUL Inglenook , 12 St Julians Avenue, Ludlow, SY8 1ET</u></b>  <b><u>RESOLVED GG/SW (5:2:1)</u></b> No Objection to the proposed extension and home studio, removal of boundary wall, installation of solar panels, subject to bat protection order being upheld.	Submit comments to Shropshire Council	CA	15/01/2025	Completed
REP/25/244	<b><u>24/04771/FUL The Orchard , Linney, Ludlow, SY8 1EE.</u></b>  <b><u>RESOLVED GG/DT (unanimous)</u></b> No Objection to replacement porch, fenestration changes and internal remodelling, subject to an ecological survey being undertaken.	Submit comments to Shropshire Council	CA	15/01/2025	Completed
REP/25/245	<b><u>25/00022/TCA The Orchard , Linney, Ludlow, SY8 1EE</u></b>  <b><u>RESOLVED GG/RH (7:0:1)</u></b> No Objection to felling and replacing 2no. conifers (T1 & T2) and 1no. Sycamore (T3) within Ludlow Conservation Area	Submit comments to Shropshire Council	CA	15/01/2025	Completed
REP/25/246	<b><u>24/04775/LBC 26 Bell Lane, LudlowSY8 1BN</u></b>  <b><u>RESOLVED SW/SH (6:2:0)</u></b> No Objection to the minor internal alterations, removal of two walls on ground floor, creation of two new shower rooms on 1st and 2nd floors, removal of wall on 2nd floor.	Submit comments to Shropshire Council	CA	15/01/2025	Completed
REP/25/247	<b><u>24/04871/TCA 14 St Marys Lane, Ludlow, SY8 1DZ</u></b>	Submit comments to Shropshire	CA	15/01/2025	Completed

**Representational Committee**  
**ITEMS TO ACTION**

**11.02.2025**

	<p><b><u>RESOLVED DT/SW (7:1:0)</u></b>          No Objection to felling 3no. Cherry trees and thin and reduce crown by 20 percent 1no. Cherry tree within Ludlow Conservation Area</p>	Council			
REP/25/248	<p><b><u>25/00032/TCA Stanford House, 15 Broad Street, Ludlow, SY8 1NG</u></b></p> <p><b><u>NOT CARRIED SH/VP (4:5:0)</u></b> (Chair used his casting vote against the motion)          To Object to the felling of 1no. London Plane within Ludlow Conservation Area</p> <p><b><u>RESOLVED GG/SW (5:4:0)</u></b> (Chair used his casting vote in support of the motion)          No Objection to the felling of 1no. London Plane within Ludlow Conservation Area</p>	Submit comments to Shropshire Council	CA	15/01/2025	Completed
REP/25/249	<p><b><u>25/00103/TCA Betjeman Lodge, Corve Street, Ludlow, SY8 1DJ</u></b></p> <p><b><u>RESOLVED GG/RH (unanimous)</u></b>          To Object reducing the crowns by 30 percent of 6no. Sycamore trees within Ludlow Conservation Area for the following reasons:          i) Site plans show trees are outside the property boundary</p>	Submit comments to Shropshire Council	CA	15/01/2025	Completed
REP/25/251	<p><b><u>BUILDINGS, BUILDING LAND AND TREES</u></b></p> <p><b><u>RESOLVED GG/RH (unanimous)</u></b>          To note the spreadsheet information.          To add to the spreadsheet          vii) That Shropshire Council reinstate the cobbles that have been replaced with concrete, after utility works, on Broad Gate Broad Street and Brand Lane.          viii) That Shropshire Council visit the site of the Old Trouser factory on Old Street to investigate concerns that the structure of the property is</p>	Contact Shropshire Council	CA	15/01/2025 8	Ongoing

**Representational Committee**  
**ITEMS TO ACTION**

**11.02.2025**

	<p>failing due to damage to the roof.          That Shropshire Council repair the deteriorating potholes on Broad Street down to Ludford Bridge.</p>				
REP/25/251	<p><b><u>TREE PROTECTION ORDERS (TPO) IN LUDLOW AND SURROUNDING PARISHES</u></b></p> <p><b><u>RESOLVED TG/GG (unanimous)</u></b>          Write to Shropshire Council to confirm          i) that the Walnut tree on St Johns Lane 2/3 way up has a TPO          ii) the status of the sycamore tree on the corner of Temeside &amp; Old Street (that has been cut down).          iii) that the walnut tree will be added to the TPO list.</p>	Contact Shropshire Council	CA	15/01/2025 8	Ongoing
<b>REP meeting 17/12/2024</b>	<b><u>ITEM</u></b>	<b><u>ACTION</u></b>		<b><u>DATE</u></b>	<b><u>STATUS</u></b>
REP/24/226	<p><b><u>ROAD CLOSURE/ TRAFFIC MANAGEMENT</u></b></p> <p><b><u>RESOLVED GG / TG (unanimous)</u></b>          To note the road closures and traffic management.</p>	Noted	CA	17/12/24	Completed
REP/24/227	<p><b><u>BUILDINGS, BUILDING LAND AND TREES</u></b></p> <p><b><u>RESOLVED TG / GG (unanimous)</u></b>          To note the spreadsheet information. Write to Shropshire Council to obtain a comprehensive list of all the TPO's in Ludlow.</p>	Noted	CA	17/12/24	Completed
REP/24/228	<p><b><u>GOVERNMENT PLEDGES TO UNLEASH BIGGEST BUILDING BOOM IN ENGLAND IN HALF A CENTURY</u></b></p> <p><b><u>RESOLVED GG / DT (unanimous)</u></b>          To note the government initiative.</p>	Noted	CA	17/12/24	Completed
REP/24/229	<p><b><u>NATIONAL GRID DEFERRMENT OF WORKS AT BELL LANE</u></b></p> <p><b><u>RESOLVED GG / TG (unanimous)</u></b>          To note the update that the works had been deferred</p>	Noted	CA	17/12/24	Completed

**Representational Committee**  
**ITEMS TO ACTION**

**11.02.2025**

<b>REP meeting 19/11/2024</b>	<b><u>ITEM</u></b>	<b><u>ACTION</u></b>		<b><u>DATE</u></b>	<b><u>STATUS</u></b>
REP/ 24/189	<p>until 2026.</p> <p><b><u>PLANNING APPLICATIONS</u></b></p> <p><b><u>REP/24/18924/04131/TCA Dinham Lodge , Dinham,Ludlow,SY8 1EH</u></b></p> <p><b><u>RESOLVED GG / SW (unanimous)</u></b> No objection to felling 1no 1 no Turkish Hazel within Ludlow Conservation Area.</p>	Comments submitted to Shropshire Council	CA	20/11/2024	Completed
REP/24/190	<p><b><u>24/04205/FUL The Gate House , Tower Street, Ludlow, SY8 1RL</u></b></p> <p><b><u>RESOLVED GG / BW ( unanimous )</u></b> No objection to the front and rear single storey extension, replacement of windows and internal reordering.</p>	Comments submitted to Shropshire Council	CA	20/11/2024	Completed
REP/24/191	<p><b><u>24/04225/FUL 11 Orchard Gardens, Ludlow, SY8 1HE</u></b></p> <p><b><u>RESOLVED GG / SW ( unanimous )</u></b> No objection to the installation of an air source heat pump</p>	Comments submitted to Shropshire Council	CA	20/11/2024	Completed
REP/24/192	<p><b><u>24/03973/LBC 32 Mill Street, Ludlow, SY8 1BG</u></b></p> <p><b><u>RESOLVED VP / BW (unanimous)</u></b> No objection to the replacement of an existing rooflight with larger rooflight to provide emergency means of escape</p>	Comments submitted to Shropshire Council	CA	20/11/2024	Completed
REP/24/193	<p><b><u>24/03984/FUL Proposed dwelling North Of 18, Stanton Road, Ludlow</u></b></p> <p><b><u>RESOLVED GG / BW (unanimous)</u></b> To object to the erection of single storey dwelling for the following reasons:</p>	Comments submitted to Shropshire Council	CA	20/11/2024	Completed

**Representational Committee**  
**ITEMS TO ACTION**

**11.02.2025**

	<ul style="list-style-type: none"> <li>• Over development of the site</li> <li>• The footprint of the proposed dwelling is too large for the site.</li> </ul>				
REP/24/194	<p><b><u>24/04004/FUL Proposed Dwelling To The West Of, Portcullis Lane,Ludlow</u></b></p> <p><b>RESOLVED GG / SW (unanimous)</b> No objection to the single dwelling.</p>	Comments submitted to Shropshire Council	CA	20/11/2024	Completed
REP/24/195	<p><b><u>24/04005/LBC Proposed Dwelling To The West Of, Portcullis Lane, Ludlow</u></b></p> <p><b>RESOLVED GG / SW (unanimous)</b> No objection to the single dwelling.</p>	Comments submitted to Shropshire Council	CA	20/11/2024	Completed
REP/24/196	<p><b><u>24/04122/LBC Laurence House , 4 Mill Street, Ludlow, SY8 1AZ</u></b></p> <p><b>RESOLVED GG / BW (unanimous)</b> No objection to the proposed internal and external works.</p>	Comments submitted to Shropshire Council	CA	20/11/2024	Completed
REP/24/197	<p><b><u>24/04219/FUL 88 Stanton Road, Ludlow, SY8 2PF</u></b></p> <p><b>RESOLVED GG / SW (unanimous)</b> No objection to the erection of part single and part two storey side extension and internal alterations following demolition of existing double garage Erection of part single and part two storey side extension and internal alterations following demolition of existing double garage. Enclosed existing open porch. Enclosed existing open porch</p>	Comments submitted to Shropshire Council	CA	20/11/2024	Completed
REP/24/198	<p><b><u>24/04326/TCA Fairwater, Linney, Ludlow, SY8 1EG</u></b></p> <p><b>RESOLVED GG / SW (unanimous)</b> No objection to the reduce by 20-30% 1no Silver</p>	Comments submitted to Shropshire Council	CA	20/11/2024	Completed



**Representational Committee**  
**ITEMS TO ACTION**

**11.02.2025**

	Birch within Ludlow Conservation Area				
REP/24/199	<p><b><u>24/04195/TCA Ludlow College, Castle Square, Ludlow, SY8 1GD</u></b></p> <p><b><u>RESOLVED GG / SW (unanimous)</u></b>            No objection to felling 1no Ash and replant with different species within Ludlow Conservation Area.</p>	Comments submitted to Shropshire Council	CA	20/11/2024	Completed
REP/24/200	<p><b><u>24/04007/TCA Manna Oak, 14 Mill Street, Ludlow, SY8 1BE</u></b></p> <p><b><u>RESOLVED GG / VP (unanimous)</u></b>            No objection to felling 1no. Silver Birch (T1), reduce in height by approx. 1/3 to previous points 3no. Leylandii (T2-4) and reduce by 50% leaving trunk approx. 7' high 1no. dead Apple tree (T5) within Ludlow Conservation Area</p>	Comments submitted to Shropshire Council	CA	20/11/2024	Completed
REP/24/201	<p><b><u>24/04364/TCA8 Corve Street, Ludlow, Shropshire, SY8 1DA</u></b></p> <p><b><u>RESOLVED GG / BW (unanimous)</u></b>            No objection to the reduction in height by 50 percent and pollard (see schedule) 1no. Sycamore (T1) within Ludlow Conservation Area</p>	Comments submitted to Shropshire Council	CA	20/11/2024	Completed
REP/24/202	<p><b><u>24/03491/LBC The Corner House 2 - 4 Old Street Ludlow SY8 1NP</u></b></p> <p><b><u>RESOLVED GG / BW (unanimous)</u></b>            That upon receipt of further information, there was no objection to the replacement of 2No. windows on the first and second floors.</p>	Comments submitted to Shropshire Council	CA	20/11/2024	Completed
REP/24/205	<p><b><u>PAVEMENT PERMIT APPLICATION</u></b></p> <p><b><u>RESOLVED GG / BW (unanimous)</u></b>            To strongly object to Area 3 because it is situated on an essential access route to Ludlow Castle and it encroaches onto essential public amenity</p>	Comments submitted to Shropshire Council	GW		Ongoing

**Representational Committee**  
**ITEMS TO ACTION**

**11.02.2025**

	space. That there is no objection to area 1 and area 2.				
REP/24/206	<p><b><u>PLACE PLAN PROJECT</u></b></p> <p><b><u>RESOLVED BW / GG (unanimous)</u></b>          To approve submission of a Place Plan project to lower the kerb outside Station Drive Surgery due to the urgent H&amp;S requirement to reduce the risk of a fatality due to slips and falls into the carriageway.</p>	To create submission	GW		complete
REP/24/207	<p><b><u>RECOMMENDED BW / GG (unanimous)</u></b>          To recommend to Full Council that the unallocated CIL of £1,665.00 is committed to this project.</p>	To recommend to Full Council in January 2025	GW		Pending
REP/24/208	<p><b><u>RESOLVED BW / GG (4:0:1)</u></b>          That Ludford Parish Council is asked to contribute funding to match Ludlow's contribution from their unallocated CIL monies.</p>	Write to Ludford Parish Council	GW		Complete
REP/24/209	<p><b><u>LUDLOW BUS SERVICE</u></b></p> <p><b><u>RESOLVED GG / SW (unanimous)</u></b>          To note the tabled update provided by Unitary Councillor Boddington.          To request maps of the new bus route from Shropshire Council, and that the committee would wait until revised bus timetable is released before making further comment.</p>	Write to Shropshire Council	GW		Complete
REP/24/211	<p><b><u>EMPTY HIGH STREET PROPERTIES</u></b></p> <p><b><u>RESOLVED GG / BW (unanimous)</u></b>          To note the update provided and to ask Shropshire Council to confirm if it applies to listed buildings.</p>	Write to Shropshire Council	CA		Complete
REP meeting 24/09/2024	<b><u>ITEM</u></b>	<b><u>ACTION</u></b>		<b><u>DATE</u></b>	<b><u>STATUS</u></b>
REP/24/133	<b><u>24/03347/FUL Lloyds Bank Plc, Bank House, 16</u></b>	Comments	CA	25/09/2024	Completed

**Representational Committee**  
**ITEMS TO ACTION**

**11.02.2025**

	<p><b><u>Broad Street, Ludlow, SY8 1NQ</u></b>  Repairs to part flat roof/perspex sheeting and pitch slate roofs</p> <p><b><u>RESOLVED GG/DT (unanimous)</u></b>  No Objection</p>	submitted to SC			Completed
REP/24/134	<p><b><u>24/03348/LBC Lloyds Bank Plc, Bank House, 16 Broad Street, Ludlow, SY8 1NQ</u></b>  Repairs to part flat roof/perspex sheeting and pitch slate roofs</p> <p><b><u>RESOLVED GG/DT (unanimous)</u></b>  No Objection</p>	Comments submitted to SC	CA	25/09/2024	
REP/24/135	<p><b><u>24/03329/FUL 27 St Margaret Road, Ludlow, SY8 1XN</u></b>  Side extension and replace existing windows</p> <p><b><u>RESOLVED GG/SW (6:0:1)</u></b>  No objection</p>	Comments submitted to SC	CA	25/09/2024	
REP/24/136	<p><b><u>24/03421/ADV TESCO, Corve Street, Ludlow, SY8 2PG</u></b>  Application to display two wall mounted vinyl panels and three pole mounted promotional banners</p> <p><b><u>RESOLVED GG/VP (unanimous)</u></b>  No Objection</p>	Comments submitted to SC	CA	25/09/2024	
REP/24/137	<p><b><u>24/03395/VAR Tesco , Corve Street, Ludlow, SY8 2PG</u></b>  Variation of Condition No. 16 attached to permission SS/1/8850/P dated 21 July 1998</p> <p><b><u>RESOLVED RJ/SW (6:1:0)</u></b>  No Objection</p>	Comments submitted to SC	CA	25/09/2024	

**Representational Committee**  
**ITEMS TO ACTION**

**11.02.2025**

REP/24/138	<p><b><u>24/03403/FUL 2 St Stephens Close, Ludlow, SY8 1QQ</u></b>  Alterations and additions to dwelling to include erection of replacement porch and glazed infill extension.</p> <p><b><u>RESOLVED DT/SH (unanimous)</u></b>  No objection</p>	Comments submitted to SC	CA	25/09/2024	Completed
REP/24/139	<p><b><u>24/03237/FUL 11 High Street, Ludlow, SY8 1BS</u></b>  Change of use of a portion of ground floor to C3 residential use</p> <p><b><u>RESOLVED GG/SW (unanimous)</u></b>  No objection</p>	Comments submitted to SC	CA	25/09/2024	Completed
REP/24/140	<p><b><u>24/03238/LBC 11 High Street, Ludlow, SY8 1BS</u></b>  Change of use of a portion of ground floor to C3 residential use.</p> <p><b><u>RESOLVED GG/SW (unanimous)</u></b>  No objection.</p>	Comments submitted to SC	CA	25/09/2024	Completed
REP/24/141	<p><b><u>24/03294/FUL 25 Raven Lane, Ludlow, SY8 1BW</u></b>  Single storey rear extension and alterations</p> <p><b><u>RESOLVED GG/RJ (unanimous)</u></b>  No objection.</p>	Comments submitted to SC	CA	25/09/2024	Completed
REP/24/142	<p><b><u>24/03295/LBC 25 Raven Lane, Ludlow, SY8 1BW</u></b>  Single storey rear extension and alterations</p> <p><b><u>RESOLVED GG/RJ (unanimous)</u></b>  No objection.</p>	Comments submitted to SC	CA	25/09/2024	Completed
REP/24/143	<p><b><u>24/03491/LBC The Corner House, 2 - 4 Old Street, Ludlow, SY8 1NP</u></b>  To replace 2No. windows on the first and second floors</p> <p><b><u>RESOLVED GG/BW (unanimous)</u></b></p>	Comments submitted to SC	CA	25/09/2024	Completed

**Representational Committee**  
**ITEMS TO ACTION**

**11.02.2025**

	To Object for the following reasons: i) Insufficient information and no drawings ii) A written report is required to explain why the windows can't be repaired instead of being replaced				
REP/24/144	<b><u>24/03473/TCA 145 Corve Street, Ludlow, SY8 2PG</u></b> Crown lift to 4m and reduce crown on garden side to approx. 6m (See Report) of 1no Norway Maple within Ludlow Conservation Area  <b><u>RESOLVED GG/VP (unanimous)</u></b> No objection.	Comments submitted to SC	CA	25/09/2024	Completed
REP/24/145	<b><u>24/03505/TCA Ludlow College, Lower Mill Street, Ludlow, SY8 1BH</u></b> Reduce by 30% 2no Bird Cherry, 1no Walnut and 1no Hornbeam, reduce back as part of annual cut 2no Laurel, remove branch of 1no Silver Birch and cut back overhanging branches of group of Hazel within Ludlow Conservation Area  <b><u>RESOLVED GG/RJ (unanimous)</u></b> No objection	Comments submitted to SC	CA	25/09/2024	Completed
REP/24/146	<b><u>24/03527/TCA Friars Cottage, 91 Old Street, Ludlow, SY8 1NU</u></b> 20% crown reduction of 1no. Acer (T1), 20% crown reduction of 1no. Magnolia (T2) and 30% crown reduction of 1no. Cotinus (T3) within Ludlow (Galdeford) Conservation Area  <b><u>RESOLVED GG/DT (unanimous)</u></b> No objection	Comments submitted to SC	CA	25/09/2024	Completed
REP/24/148	<b><u>ROAD CLOSURE/TRAFFIC MANAGEMENT</u></b>  <b><u>RESOLVED GG/VP (unanimous)</u></b> To note the closures and obtain clarification on timescales at Temeside.	To note and write to Shropshire Council			

**Representational Committee**  
**ITEMS TO ACTION**

**11.02.2025**

REP/24/149	<b><u>BUILDINGS BUILDING LAND AND TREES</u></b>  <b><u>RESOLVED VP/GG (unanimous)</u></b> To add to the spreadsheet concern over the structure of the historic well on Livesey Road for following up with Shropshire Council.	Add to spreadsheet	CA		
REP/24/150	<b><u>PLACE PLAN UPDATE</u></b> To consider the place plan update information  <b><u>RESOLVED SW/GG (unanimous)</u></b> To consider and discuss at next meeting in October.	To consider and discuss at next meeting in October.			
<b>REP Meeting 27/08/2024</b>	<b><u>ITEM</u></b>	<b><u>ACTION</u></b>		<b><u>DATE</u></b>	<b><u>STATUS</u></b>
24/103	<b><u>24/01648/FUL J P S SUPPLIES, ORLETON ROAD, LUDLOW, SY8 1XF</u></b>  <b><u>RESOLVED GG/BW (unanimous)</u></b> No objection	Comments submitted to SC	KA	29.8.2024	Completed
24/104	<b><u>24/02892/FUL &amp; 24/02893/LBC PROPOSED CONVERSION OF OUTBUILDING TO THE EAST OF RAVEN LANE, LUDLOW</u></b>  <b><u>RESOLVED DT/GG (unanimous)</u></b> No Objection	Comments submitted to SC	KA	29.8.2024	Completed
24/105	<b><u>24/02987/TPO LUDLOW MOTORS, BURWAY TRADING ESTATE, BROMFIELD ROAD, LUDLOW, SY8 1EN</u></b>  <b><u>RESOLVED GG/DT (unanimous)</u></b> To object for the following reasons: The works seems too extensive for a tree protected by a TPO, and there is no report from Shropshire Councils Tree Officer as to whether the works are appropriate and in the best interests of the future health of the tree. Ludlow Town Council are not able to support an	Comments submitted to SC	KA	29.8.2024	Completed

**Representational Committee**  
**ITEMS TO ACTION**

**11.02.2025**

	application for works to a tree with a TPO without professional guidance from Shropshire Council's Tree Officer.				
24/106	<b><u>24/03073/TCA 9 CAMP LANE, LUDLOW, SY8 1EG</u></b>  <b><u>RESOLVED GG/RH (unanimous)</u></b> No Objection	Comments submitted to SC	KA	29.8.2024	Completed
24/107	<b><u>24/03074/TCA DINHAM HALL, DINHAM, LUDLOW, SY8 1EJ</u></b>  <b><u>RESVOLVED GG/BW (unanimous)</u></b> To object for the following reasons: The tree has significant public amenity, and the proposed pruning is too severe, and the amenity value would be lost. The Committee propose that pruning back to one third of the proposed works would be sufficient and maintain the public amenity value of the tree.	Comments submitted to SC	KA	29.8.2024	Completed
24/108	<b><u>24/03064/VAR BEECH HOUSE, 41 NEW ROAD, LUDLOW, SY8 2NY</u></b>  <b><u>RESOLVED GG/RH (unanimous)</u></b> To object to the variation for the following reasons: The proposed variation is not a minor amendment to an existing permission. The scale and scope of the proposed changes are very extensive and a new FUL planning application should be made.	Comments submitted to SC	KA	29.8.2024	Completed
24/109	<b><u>24/03144/TPO LUDLOW CE SCHOOL, BROMFIELD ROAD, LUDLOW, SY8 1GJ</u></b>  <b><u>RESOLVED GG/DT (unanimous)</u></b> To object to the proposal for the following reasons: There is no justification for the works. The trees are protected by a TPO. The shape of the trees is magnificent and should be retained and protected. The only works that are appropriate is the removal of	Comments submitted to SC	KA	29.8.2024	Completed

**Representational Committee**  
**ITEMS TO ACTION**

**11.02.2025**

	the ivy. Ludlow Town Council would like a report from Shropshire Council's Tree Officer.				
24/110	<b><u>24/03165/FUL 28 QUARRY PLACE, LUDLOW, SY8 2LU</u></b>  <b><u>RESOLVED GG/RH (unanimous)</u></b> No Objection.	Comments submitted to SC	KA	29.8.2024	Completed
24/111	<b><u>24/03138/FUL AND 24/03139/LBC 124 CORVE STREET, LUDLOW, SY8 2PG</u></b>  <b><u>RESOLVED GG/SW (unanimous)</u></b> No objection.	Comments submitted to SC	KA	29.8.2024	Completed
24/113	<b><u>BUILDINGS, BUILDING LAND AND TREES</u></b>  <b><u>RESOLVED VP/GG (unanimous)</u></b> To add two queries for following up with Shropshire Council: <ul style="list-style-type: none"> <li>• Wicked Van Hire site on Weeping Cross – does the signage have permission and does the permitted use for the site include storage facilities.</li> </ul> Wicked Van Hire site on Temeside – notify that the front wall has fallen down and needs to be rebuilt.	Email to SC	CA	02/09/2024	Ongoing
24/115	<b><u>NEIGHBOURHOOD PLAN AND DESIGN CODES</u></b>  <b><u>RECOMMEND GG/BW (unanimous)</u></b> To recommend to Full Council that a task and finish group is set up to explore the stages of creating a Neighbourhood Plan and that all Councillors are eligible to join.		GW	24/08/2024	Ongoing
24/116	<b><u>BUS SHELTER</u></b>  <b><u>RESOLVED GG/SW (unanimous)</u></b> To approve in principle the installation of a 2-bay size Invincible design bus shelter at Tollgate Road bus stop in this financial year (2024/25).		GW	24/08/2024	Ongoing
24/117	<b><u>RECOMMEND GG/BW (unanimous)</u></b> To recommend that Full Council approve the		GW	24/08/2024	Ongoing



**ITEMS TO ACTION**

	refurbishment of the Mill Street bus shelter in the next financial year; and that quotes are obtained to enable an appropriate budget to be set.				
24/118	<p><b><u>NATIONAL GRID – BELL LANE</u></b></p> <p><b><u>RESOLVED GG/BW (unanimous)</u></b>                  To note that planned infrastructure improvements are needed to avoid unplanned emergency works and that National Grid will engage in comprehensive communication with the local community.                  That further to the measures already being considered, which include 6-day working to reduce the impact on the town, National Grid also look at further ways to reduce the impact on the businesses of the town.                  That National Grid contact Ludlow Chamber of Trade and the wider business community to make them aware of the proposal and timescales of the work, and specifically hold discussions with businesses that usually received their deliveries on a large lorry that would not be able to navigate the diversion route.                  That National Grid attend the next Committee meeting.</p>		GW	24/08/2024	Ongoing
<b>Rep meeting 30/07/2024</b>	<b><u>ITEM</u></b>	<b><u>ACTION</u></b>		<b><u>DATE</u></b>	<b><u>STATUS</u></b>
24/074	<p><b><u>24/02455/FUL 21 Kennet Bank, Ludlow, SY8 1LL</u></b></p> <p><b><u>RESOLVED GG/SW (unanimous)</u></b>                  No Objection</p>	Comments submitted to SC	CA	31/07/2024	Completed
24/075	<p><b><u>24/02486/LBC 68 Corve Street, Ludlow, SY8 1DU</u></b></p> <p><b><u>RESOLVED GG/SW (unanimous)</u></b>                  No Objection</p>	Comments submitted to SC	CA	31/07/2024	Completed

**Representational Committee**  
**ITEMS TO ACTION**

**11.02.2025**

24/076	<b><u>24/02568/FUL 12 Keepside Close, Ludlow, SY8 1BQ</u></b>  <b><u>RESOLVED GG/DT (unanimous)</u></b> No Objection	Comments submitted to SC	CA	31/07/2024	Completed
24/077	<b><u>24/02711/TCA Brechans, Camp Lane, Ludlow, SY8 1EQ.</u></b>  <b><u>RESOLVED GG/SW (unanimous)</u></b> No Objection	Comments submitted to SC	CA	31/07/2024	Completed
24/078	<b><u>24/02628/FUL The Manz , 26 Steventon Crescent, Ludlow, SY8 1JS</u></b>  <b><u>RESOLVED GG/SW (unanimous)</u></b> No Objection	Comments submitted to SC	CA	31/07/2024	Completed
24/079	<b><u>24/02688/TCA Hillcrest , 59 Gravel Hill, Ludlow, SY8 1QS</u></b>  <b><u>RESOLVED GG/DT (unanimous)</u></b> No Objection	Comments submitted to SC	CA	31/07/2024	Completed
24/080	<b><u>24/02501/FUL Aquila House, Riddings Road, Ludlow, SY8 1HR</u></b>  <b><u>RESOLVED GG/SW (unanimous)</u></b> No Objection	Comments submitted to SC	CA	31/07/2024	Completed
24/081	<b><u>24/02696/FUL 8 Blashfield Road, Ludlow, SY8 1UE</u></b>  <b><u>RESOLVED GG/DT (unanimous)</u></b> No Objection	Comments submitted to SC	CA	31/07/2024	Completed
24/082	<b><u>ROAD CLOSURE/TRAFFIC MANAGEMENT</u></b>  <b><u>RESOLVED GG/BW (unanimous)</u></b> To note the closures. To write to Shropshire Council to clarify the difference between traffic control / give and take.	Write to Shropshire Council for clarification			
24/083	<b><u>BUILDINGS BUILDING LAND AND TREES</u></b>  <b><u>RESOLVED GG/DT (unanimous)</u></b> To add the information regarding the overhanging hedge	Report via 'fix my street'	CA	31/07/2024	Completed

	at Station Drive to Shropshire Council.				
<b>24/084</b>	<p><b><u>CONSULTATION: ON-STREET PARKING CHARGES</u></b></p> <p><b><u>RESOLVED GG/BW (unanimous)</u></b>          To responds to Shropshire Council as follows:</p> <p><b>On-Street Parking Charges</b>          Ludlow Town Council does not support Shropshire Council’s proposals to increase on-street parking charges in Ludlow. The parking charges are already too high for a small town – further increases of between 10 – 25% are not justifiable.</p> <p>Ludlow is a small and popular market town – people want to visit because it is attractive and has good amenities and attractions for visitors, but charging excessively for parking will not encourage visitors to the town.</p> <p>Shropshire Council (SC) reasons to justify the increases are not workable. The high parking charges are presented as a discerning deterrent that will displace parking to preferred areas. This is the wrong approach – overcharging will have a detrimental effect. The Town Council welcomes positive investment from Shropshire Council to improve bus services, but charging excessively for parking will harm the town.</p> <p>Ludlow Town Council understands that fees do need to increase occasionally, and an increase in line with inflation at 2-3 % would support the long-term sustainability of the town.</p>	To respond to the consultation	GW		
<b>24/085</b>	<p><b><u>CONSULTATION: CAR PARKING CHARGES</u></b></p> <p><b><u>RESOLVED GG/BW (unanimous)</u></b></p> <p><b>Car Parking Charges</b>          Ludlow Town Council does not support Shropshire Council’s proposals to increase car park parking charges</p>	To respond to the consultation	GW		

**ITEMS TO ACTION**

	<p>at Castle Street, Galdeford zone A and B, and Smithfield. Shropshire Council reasons to justify the increases are not workable. In some cases, the increases are as much 40-50%. High parking charges will deter residents from the surrounding area from using Ludlow and may even encourage them to use towns in Herefordshire with lower parking charges.</p> <p>The high parking charges are presented as a discerning deterrent that will displace parking to preferred areas. However, this is the wrong approach – overcharging will have detrimental effects. The Town Council welcomes positive investment from Shropshire Council to improve bus services, but charging excessively for parking will harm the town.</p> <p>Ludlow is a small and popular market town – people want to visit because it is attractive and has good amenities and attractions for visitors, but charging excessively for parking will not encourage visitors to the town.</p> <ul style="list-style-type: none"> <li>• Ludlow Town Council understands that fees do need to increase occasionally, and an increase in line with inflation at 2-3 % would support the long-term sustainability of the town.</li> </ul>			
<p><b>24/086</b></p>	<p><b><u>CONNEXUS HOUSING</u></b></p> <p><b><u>RESOLVED GG/RJ (unanimous)</u></b>                  To note the number of homes Connexus have built /bought as follows:                  12 new homes at Sheet Road, Ludlow (purchased from Shropshire Homes) in 2022                  1 x 4/5 bed house to be purchased imminently in Parys Road, Ludlow                  21 new homes planned for Riddings Road, Ludlow (planning application to be submitted shortly)</p>	<p>No action, to note</p>		<p>Complete</p>
<p><b>24/087</b></p>	<p><b><u>BUS SHELTER</u></b></p>			<p>Ongoing</p>

**Representational Committee**  
**ITEMS TO ACTION**

**11.02.2025**

	<p><b><u>RESOLVED GG/SW (unanimous)</u></b>          To not increase the size of the pavement tarmac at Parys Road / Travis Perkins site and to review the consultation information for an alternative location.</p>	To explore options at the next location.	KA		
24/088	<p><b><u>NEIGHBOURHOOD PLAN AND DESIGN CODES</u></b></p> <p><b><u>RESOLVED GG/BW (unanimous)</u></b>          To discuss the process at the next meeting.</p>	To be brought to next Rep meeting.	CA/ GW		
<b>REP Meeting 02/07/2024</b>	<b><u>ITEM</u></b>	<b><u>ACTION</u></b>		<b><u>DATE</u></b>	<b><u>STATUS</u></b>
24/047	<p><b><u>PLANNING APPLICATIONS</u></b></p> <p><b><u>24/01903/LBC Riverside , 18 Temeside, Ludlow, SY8 1PD</u></b></p> <p><b><u>RESOLVED GG/RH (unanimous)</u></b>          No Objection to the proposed alterations and improvements</p>	Comments submitted to SC	CA	03/07/2024	Complete
24/048	<p><b><u>24/02016/FUL 4 Raven Lane, Ludlow, SY8 1BW</u></b></p> <p><b><u>RESOLVED TG/RH (unanimous)</u></b>          To object to the proposed refurbishment and internal alterations for the following reasons:          i) The existing plans are incomplete and do not show the cellar area.          ii) The proposed plans show the cellar area, but there is no corresponding existing plan for comparison to understand the scope of the changes. For this reason, it is not possible to make a meaningful comment on the plans.</p>	Comments submitted to SC	CA	03/07/2024	Complete
24/049	<p><b><u>24/02017/LBC 4 Raven Lane, Ludlow, SY8 1BW</u></b></p> <p><b><u>RESOLVED TG/RH (unanimous)</u></b>          To object to the proposed refurbishment and internal alterations for the following reasons:</p>	Comments submitted to SC	CA	03/07/2024	Complete

**ITEMS TO ACTION**

	<p>i) The existing plans are incomplete and do not show the cellar area.</p> <p>ii) The proposed plans show the cellar area, but there is no corresponding existing plan for comparison to understand the scope of the changes. For this reason, it is not possible to make a meaningful comment on the plans.</p>				
<b>24/050</b>	<p><b><u>24/01786/FUL The Market Grocer Ltd, 4 Church Street, Ludlow, SY8 1AP</u></b></p> <p><b><u>RESOLVED GG/TG (unanimous)</u></b> To object to the proposed additional three fixed awnings and internal alterations and erection of solar panels to south elevation for the following reasons:</p> <p>i) If Church Street is a designated highway with residential properties and businesses including a public house, and retail premises, the area of the pavement licence (in combination with the licence opposite) will effectively block pedestrian access and also vehicular access for deliveries and emergency services.</p> <p>ii) If Church Street is a designated highway, the awnings are too low for a designated highway, and would need to be no lower than 5.03 m</p> <p>iii)</p>	Comments submitted to SC	CA	03/07/2024	<b>Complete</b>
<b>24/051</b>	<p><b><u>24/01787/LBC The Market Grocer Ltd, 4 Church Street, Ludlow, SY8 1AP</u></b></p> <p><b><u>RESOLVED GG/TG (unanimous)</u></b> To object to the proposed additional three fixed awnings and internal alterations and erection of solar panels to south elevation for the following reasons:</p> <p>i) If Church Street is a designated highway with residential properties and businesses including a public house, and retail premises, the area of the pavement licence (in combination with the licence opposite) will effectively block pedestrian access and also vehicular</p>	Comments submitted to SC	CA	03/07/2024	<b>Complete</b>

**Representational Committee**  
**ITEMS TO ACTION**

**11.02.2025**

	<p>access for deliveries and emergency services.            ii) If Church Street is a designated highway, the awnings are too low for a designated highway, and would need to be no lower than 5.03 m</p>				
24/052	<p><b><u>24/02168/FUL Corixa , Sandpits Road, Ludlow, SY8 1HG</u></b></p> <p><b><u>RESOLVED GG/SW (unanimous)</u></b>            No Objection to the single storey side extension</p>	<p>Comments submitted to SC</p>	CA	03/07/2024	Complete
24/053	<p><b><u>24/02262/FUL 19 Bull Ring, Ludlow, SY8 1AA</u></b></p> <p><b><u>RESOLVED GG/TG (unanimous)</u></b>            To Object to the conversion of vacant ground floor shop into residential flat for the following reasons:</p> <p>i) There are no permitted development rights for the grade II listed building.            ii) The grade II listed shop frontage is a significant feature of the conservation area and the building opposite mirrors its proportions and shaping.            iii) The exterior part of the property is part of the ancient town walls, and it is not appropriate to install windows into an ancient scheduled monument.            iv) The proposed windows (in the town wall) would open outwards onto a very narrow car park access road in daily use by local businesses.            v) The claim made that high rent are a problem and shops are not being filled is a misleading argument because rents are decided by landlords (owners) so this is completely within the owner’s control, and whilst there is a high turnover of businesses at present – retail premises are being filled again.</p>	<p>Comments submitted to SC</p>	CA	03/07/2024	Complete
24/054	<p><b><u>24/02263/LBC 19 Bull Ring, Ludlow, SY8 1AA</u></b></p> <p><b><u>RESOLVED GG/TG (unanimous)</u></b>            To Object to the conversion of vacant ground floor shop into residential flat for the following reasons</p> <p>i) There are no permitted development rights for the</p>	<p>Comments submitted to SC</p>	CA	03/07/2024	Complete

**ITEMS TO ACTION**

	<p>grade II listed building.</p> <p>ii) The grade II listed shop frontage is a significant feature of the conservation area and the building opposite mirrors its proportions and shaping.</p> <p>iii) The exterior part of the property is part of the ancient town walls, and it is not appropriate to install windows into an ancient scheduled monument.</p> <p>iv) The proposed windows (in the town wall) would open outwards onto a very narrow car park access road in daily use by local businesses.</p>				
<b>24/055</b>	<p><b><u>24/02451/DIS 1 College Street, Ludlow, SY8 1AN</u></b></p> <p><b><u>RESOLVED GG/SW (unanimous)</u></b> No objection to the Discharge of Condition 3 (Work schedules relating to the roof, external walls, doors, windows, internal alterations, finishes, services and external works) for planning application number 23/04716/LBC</p>	Comments submitted to SC	CA	03/07/2024	<b>Complete</b>
<b>24/056</b>	<p><b><u>24/02337/TCA Manna Oak , 14 Mill Street, Ludlow, SY8 1BE</u></b></p> <p><b><u>RESOLVED GG/DT (unanimous)</u></b> No objection to the removal of weight from 3 stress limbs, clear tree of any deadwood &amp; tighten crown with overall reduction of 35% of 1no Mulberry (T1), side prune away from property 1no Cherry (T2) &amp; reduce crown by 30% 1no Hazel within Ludlow Conservation Area</p>	Comments submitted to SC	CA	03/07/2024	<b>Complete</b>
<b>24/057</b>	<p><b><u>PLANNING APPLICATION TO NOTE</u></b></p> <p><b><u>RESOLVED GG/SW (unanimous)</u></b> To note the planning application made by Ludlow Town Council for an information board to be located in Lower Corve Street.</p>	noted		03/07/2024	<b>Ongoing</b>
<b>24/060</b>	<p><b><u>BUS SHELTER UPDATE</u></b></p> <p><b><u>RESOLVED GG/SW (unanimous)</u></b> That Shropshire Council should provide measurements to explanation why the extra area of tarmacked is needed</p>	Write to Shropshire Council	GW		<b>Complete</b>



**Representational Committee**  
**ITEMS TO ACTION**

**11.02.2025**

	at this location				
<b>24/061</b>	<p><b><u>ELECTRICAL VEHICLE CHARGING POINTS CONSULTATION - CHARLTON RISE AND SANDPITS ROAD</u></b></p> <p><b><u>RESOLVED GG/RH (unanimous)</u></b>  That all the EV charging points should be located at the curb side to avoid trailing cables becoming a trip hazard.</p>	Write to Shropshire Council	GW		Ongoing
<b>REP Meeting 04/06/2024</b>	<b><u>ITEM</u></b>	<b><u>ACTION</u></b>		<b><u>DATE</u></b>	<b><u>STATUS</u></b>
<b>24/016</b>	<p><b><u>PLANNING APPLICATIONS</u></b>  <b><u>24/01648/FUL J P S Supplies, Orleton Road, Ludlow, SY8 1XF</u></b>  Erection of a single storey side extension and dropped kerb</p> <p><b><u>RESOLVED GG/RJ (unanimous)</u></b>  No Objection</p>	Comments submitted to SC	CA	05/06/2024	<b>COMPLETE</b>
<b>24/017</b>	<p><b><u>24/01441/FUL Hillcrest And Barn, Old Brickyard, New Road, Ludlow, SY8 2LT</u></b>  Conversion of existing agricultural barn and first floor flat to form 4No dwellings and formation of vehicular access</p> <p><b><u>RESOLVED GG/RJ (unanimous)</u></b>  No objection</p>	Comments submitted to SC	CA	05/06/2024	<b>COMPLETE</b>
<b>24/018</b>	<p><b><u>24/01746/FUL Chadwick House , Burway Lane, Ludlow, SY8 1DT</u></b>  Erection of first floor extension and double garage</p> <p><b><u>RESOLVED GG/RJ (unanimous)</u></b>  No objection</p>	Comments submitted to SC	CA	05/06/2024	<b>COMPLETE</b>
<b>24/019</b>	<p><b><u>24/01759/FUL Ridgemount, 57A Gravel Hill, Ludlow, SY8 1QS</u></b>  Replace a section of brick boundary wall and side of timber porch</p> <p><b><u>RESOLVED GG/AU (unanimous)</u></b>  To object because the proposed replacement of part brick and part timber is out of keeping within the conservation area.</p>	Comments submitted to SC	CA	05/06/2024	<b>COMPLETE</b>

**Representational Committee**  
**ITEMS TO ACTION**

**11.02.2025**

<p><b>24/020</b></p>	<p><b><u>24/01769/FUL 6 Hamlet Close, Ludlow, SY8 2NW</u></b>  Erection of single storey rear extension, installation of ramped pedestrian access and new vehicle access with hardstanding</p> <p><b><u>RESOLVED GG/RH (unanimous)</u></b>  No objection</p>	<p>Comments submitted to SC</p>	<p>CA</p>	<p>05/06/2024</p>	<p><b>COMPLETE</b></p>
<p><b>24/021</b></p>	<p><b><u>24/01810/LBC FATFACE, 59 Broad Street, Ludlow, SY8 1NH</u></b>  Repair, refurbishment, repaint of shopfront and replacement signage</p> <p><b><u>RESOLVED RJ/GG (unanimous)</u></b>  No objection</p>	<p>Comments submitted to SC</p>	<p>CA</p>	<p>05/06/2024</p>	<p><b>COMPLETE</b></p>
<p><b>24/022</b></p>	<p><b><u>24/01811/ADV FATFACE, 59 Broad Street, Ludlow, SY8 1NH.</u></b>  Signage</p> <p><b><u>RESOLVED RJ/GG (unanimous)</u></b>  No objection</p>	<p>Comments submitted to SC</p>	<p>CA</p>	<p>05/06/2024</p>	<p><b>COMPLETE</b></p>
<p><b>24/023</b></p>	<p><b><u>24/01355/FUL The Oaklands , Bromfield Road, Ludlow, SY8 1DW</u></b>  Demolition and Redevelopment to Provide a Proposed Care Home (Use Class C2: Residential Institution) and Associated Access, and Parking.</p> <p><b><u>RESOLVED GG/RJ (unanimous)</u></b></p> <p>To object for the following reasons</p> <ul style="list-style-type: none"> <li>i) Whilst there is a need for a care home facility, the committee believe that this is the wrong location.</li> <li>ii) The proposed building is an overdevelopment of the site.</li> <li>iii) The proposed building is too large and visually too dominant within the surrounding area.</li> </ul>	<p>Comments submitted to SC</p>	<p>CA</p>	<p>05/06/2024</p>	<p><b>COMPLETE</b></p>

**Representational Committee**  
**ITEMS TO ACTION**

**11.02.2025**

	iv) There is insufficient parking for the new development.				
24/024	<p><b><u>24/01683/FUL Hopedene , Fishmore Road, Ludlow, SY8 2LU.</u></b>            Installation of 1.2m high metal front gate and dropped kerb  <b><u>RESOLVED AU/GG (unanimous)</u></b></p> <p>No objection</p>	Comments submitted to SC	CA	05/06/2024	COMPLETE
24/025	<p><b><u>24/01889/FUL Aldi, Station Drive, Ludlow, SY8 2PQ</u></b>            Erection of replacement plant, enclosure and associated works  <b><u>RESOLVED RJ/RH (unanimous)</u></b>            No objection</p>	Comments submitted to SC	CA	05/06/2024	COMPLETE
24/026	<p><b><u>24/01876/FUL Castle Grange , Linney, Ludlow, SY8 1EE</u></b>            Erection of rear extension  <b><u>RESOLVED RH/GG (unanimous)</u></b>            No objection</p>	Comments submitted to SC	CA	05/06/2024	COMPLETE
24/027	<p><b><u>24/01984/TCA Friars Tilt , Linney, Ludlow, SY8 1EE</u></b>            Fell 2no. Spruce within Ludlow Conservation Area  <b><u>RESOLVED AU/GG (unanimous)</u></b>            No objection</p>	Comments submitted to SC	CA	05/06/2024	COMPLETE
24/028	<p><b><u>24/01916/LBC Linney House , Linney, Ludlow, SY8 1EE</u></b>            Replacement of 8No front facing sash windows  <b><u>RESOLVED GG/AT (unanimous)</u></b>            To object for the following reasons            i) No information regarding crown glass            ii) No information about why the existing windows cannot be repaired</p>	Comments submitted to SC	CA	05/06/2024	COMPLETE
24/029	<p><b><u>24/01960/FUL The Fruit Basket, 2/3 Church Street, Ludlow, SY8 1AP.</u></b>            Installation of 2 awnings and new shop front  <b><u>RESOLVED GG/RH (unanimous)</u></b>            To object for the following reasons</p>	Comments submitted to SC	CA	05/06/2024	COMPLETE

**ITEMS TO ACTION**

	<p>i) The height of the awnings is not stated.                  ii) The committee believes that Church Street is a designated highway, and if so, the national regulations would apply, and structures over hanging the highway should be a minimum of 5.03m high.                  iii) Access emergency services may be impeded.</p>				
24/031	<p><b><u>BUILDINGS BUILDING LAND AND TREES</u></b></p> <p><b><u>RESOLVED GG/RH (unanimous)</u></b>                  To note the spreadsheet and move completed items over 12 months</p>	noted	CA	05/06/2024	Complete
24/034	<p><b><u>PUBLIC TRANSPORT INTO LUDLOW</u></b></p> <p><b><u>RESOLVED GG/RH (unanimous)</u></b>                  To write to Shropshire Council regarding Ludlow Eco Park and Ride service stating that the current facilities are inadequate, and improvements are required to help encourage use of the park and ride because Ludlow has limited parking. The town would benefit from an effective facility including:</p> <ul style="list-style-type: none"> <li>• Improved shelter</li> <li>• Current bus information displayed at the bus shelter</li> <li>• A public toilet facility</li> <li>• A public phone</li> <li>• Digital signage with information about changes to bus services</li> <li>• Working CCTV cameras that can be viewed by Ludlow police</li> <li>• Repairs to the surface matting</li> <li>• Directional signage on the A49</li> </ul>	Letter to SC	GW	05/06/2024	COMPLETE
24/264	<p><b><u>ROAD CLOSURE/ TRAFFIC MANAGEMENT</u></b></p> <p><b><u>RESOLVED RP/DT (7:3:0)</u></b>                  To note the first and last two road closures.</p> <p>To object to the third traffic management listed in Mill Street for the following reasons</p> <p>i) It was understood that the bays outside Douglas Attire would return to general parking.                  ii) Still awaiting the definition and correct siting of the EV</p>	Comments to be submitted to Shropshire Council	GW	05/06/2024	Ongoing

**ITEMS TO ACTION**

	charging bays at Upper Mill Street.				
--	-------------------------------------	--	--	--	--

**Item 13**

**BUILDING BUILDING LAND AND TREES**

**Buildings, Building Land and Trees Report**

DATE	Query	Action	Response	Further updates
30/07/2024	Clr Thompson reported that the trees on Station drive need attention as it is overgrown therefore pedestrians are having to step into the road.	31/07/2024	CA reported on SC interactive report it map - await response	
28/08/2024	Wicked Van Hire site on Weeping Cross - does the signage have permission and does the permitted use for the site include storage facilities.	28/08/2024	CA emailed SC await reply received 03/09/2024	With regard to your email, the rebuilding of the wall is not a planning issue and I would suggest you contact the owner of the land directly to discuss this matter. The signage may not require planning permission, it would depend on the size and what it is advertising. The regulations regarding advertisements consents can be found via the following link: untitled (publishing.service.gov.uk) The use of the building as storage, it is unclear from your email what is being stored? Again it may be acceptable but without knowing what is being stored and the timescales I am unable to answer this query. Regards Elizabeth Griffiths Technical Support Supervisor (South Team) Development Management Places Directorate
28/08/2024	Wicked Van Hire site on Temeiside - notify that the front wall has fallen down and needs to be rebuilt.	29/08/2024	CA emailed SC reply received 03/09/2024	With regard to your email, the rebuilding of the wall is not a planning issue and I would suggest you contact the owner of the land directly to discuss this matter. The signage may not require planning permission, it would depend on the size and what it is advertising. The regulations regarding advertisements consents can be found via the following link: untitled (publishing.service.gov.uk) The use of the building as storage, it is unclear from your email what is being stored? Again it may be acceptable but without knowing what is being stored and the timescales I am unable to answer this query. Regards Elizabeth Griffiths Technical Support Supervisor (South Team) Development Management Places Directorate
24/09/2024	Historical monument (well) and TPO on Livesey Road Ludlow	24/09/2024	to write to Shropshire Council tag the well is in disrepair and damaged	
17/10/2024	Scaffolding at New Velvet Fern Building 16 King Street	17/10/2024	CA wrote to SC as scaffolding not on one network	reply from SC Good afternoon,  Thank you for contacting Shropshire Council, this is a Streetworks issue regarding scaffolding on the public highway.  I apologise that this has pinged off the map as I was not able to extend it in time as it disappeared, but it is actually in place until at least November 1st. I will issue the license now, so it re-appears on the map again.  It is likely that another extension may be required, however I will not be able to get confirmation (of duration) until sometime next week when the property owner is back in town. It is unfortunate the scaffold is still in place, but the work is related to the building's structural integrity, so this job will supersede any restrictions that are normally in place during the lead up to Christmas.  If you like, I can give you an update once I hear back from the property owner.  Kindest Regards,  Soufia Maoulis
22.10.2024	From Representational Committee on 22.10.2024 Street lights are out in the area of the Buttercross and on Broad Street	Report to Shropshire Council - not sure if done?	CA contacted SC spoke to	
02/01/2025	Clr B Waite reported Glenholme 21 Gravel Hill having a lot of work done to it, they appear to have taken out the back wall and have damaged a lot of the front glass windows which were old Victorian ones and I cannot find any record of planning permission being asked for or granted!  It is major building works so they should have applied because it is in the conservation area	CA contacted SC spoke to	Hello Charlotte  We do not have any planning applications for the property on our system. It obviously depends on what the development is as to if they do require permission, it may be that it falls under their permitted development rights and you can check this on the planning portal website. If you believe there is a breach of planning and wish for it to be investigated then you will need to fill in an enforcement request form which can be found on the Shropshire Council website - Submit a planning enforcement query   Shropshire Council Regards Sandy Stevenson Technical Support Officer (Southern) Planning Services Place Directorate planning.southern@shropshire.gov.uk 01743 253820	Hi Charlie,  Changes to windows and doors can be done under permitted development rights, even within the conservation area. In terms of the works you mention to the rear, there are also permitted development rights for single storey rear extensions and other alterations within the conservation area, so it may be that it falls under those limits. If you think the works are outside of the permitted development rights then this would need to be reported formally via the planning enforcement form as Sandy has mentioned. Regards, Becky Rebecca Jones Senior Conservation & Design Officer (South) Historic Environment Team Place Directorate becky.jones@shropshire.gov.uk
09/01/2025	CA report to SC	CA completed form online alleged brach of planning		CA completed form online alleged brach of planning 09/01/2025  Good afternoon, Thank you for your report which has been passed to the Tree Team.  As there are no protected trees (under a TPO) and the site falls outside of any Conservation Area, our permission would not be required for any tree work. Therefore there is no enforcement issue for us to investigate.  I am sorry we are unable to assist in this matter but thank you for querying it with us.  Kind regards,  Lucy Stanley Arboricultural Technician Tree Team, Natural & Historic Environment
24/03/2024	Full erection of single storey dwelling - was refused Clr Ginger visited site and 2 trees have been removed	CA reported to Streetsworks and await reply 16/01/2025	Morning Charlie,  Becky has shared the below email with the street works team,  Item 1 - I will arrange to have the locations inspected to see if any of the reinstatements that fall within a 2 year guarantee period and if they do we will look to serve defects on the relevant Utility.  Item 3 - This will be for the local Highways team, I have copied in the relevant team but you may wish also to raise via fix my street.  Kind regards, Richard,  Richard Ealey Network Manager Team : Street Works	CA completed form online alleged brach of planning 09/01/2026 Good morning Charlie,  To provide an update, our streetworks inspector has visited the site and we have found no outstanding utility trenches that are incomplete or that we are able to defect. We have noted that there are some areas that have been disturbed, however these need to weather to be able to blend in more.  Sorry we cannot be of anymore help on this occasion.  Kind regards, Richard,  Richard Ealey Network Manager Team : Street Works Directorate : Place
14/01/2025	CA reported to Becky Jones who will investigate 15/01/2025 await reply	They were concerned about the structural integrity of the building and that it's been left standing for so long - there currently is no work being done it appears the works have come to a standstill. Thanks Charlie 15/01/2025	Hi Charlie,  I have been in contact with building control who are looking into the matter and will carry out a visual site inspection.  Regards, Becky Rebecca Jones Senior Conservation & Design Officer (South) Place Directorate becky.jones@shropshire.gov.uk	Hi Charlie,  I have been in contact with building control who are looking into the matter and will carry out a visual site inspection.  Regards, Becky Rebecca Jones Senior Conservation & Design Officer (South) Place Directorate becky.jones@shropshire.gov.uk
14/01/2025	CA reported to Streetsworks and await reply 16/01/2025	Morning Charlie,  Becky has shared the below email with the street works team,  Item 1 - I will arrange to have the locations inspected to see if any of the reinstatements that fall within a 2 year guarantee period and if they do we will look to serve defects on the relevant Utility.  Item 3 - This will be for the local Highways team, I have copied in the relevant team but you may wish also to raise via fix my street.  Kind regards, Richard,  Richard Ealey Network Manager Team : Street Works	Hi Charlie,  I have been in contact with building control who are looking into the matter and will carry out a visual site inspection.  Regards, Becky Rebecca Jones Senior Conservation & Design Officer (South) Place Directorate becky.jones@shropshire.gov.uk	Good afternoon Charlotte,  I can confirm that the potholes on Broad St have been flagged, however, I am unable to confirm a date when the repairs will be undertaken. Best wishes, Lesley Keay Administration Officer Highway Maintenance customerfirst@shropshire.gov.uk 0345 678 9006
11/02/2025	iii) That Shropshire Council repair the deteriorating pathstones on Broad Street down to Ludford Bridge Station Drive Parys Lane Dark Lane Parys Road	I reported the issues on Dark Lane , Parys Road and near Station Drive to SC, they have said  We have looked into this issue and can advise that the work required will be completed in our programme of upcoming routine maintenance	I reported the issues on Dark Lane , Parys Road and near Station Drive to SC they have said  We have looked into this issue and can advise that the work required will be completed in our programme of upcoming routine maintenance	CA has emailed SC Customer First to get a copy of the programme of upcoming maintenance  Highway Maintenance customerfirst@shropshire.gov.uk 0345 678 9006
11/02/2025	Castle street car park roots of tree causing trip hazard	CA emailed SC		----- updates on Trees and bushes We have now arranged for the required work to take place to resolve the issue you reported It appears that these jobs were closed with the incorrect message as they have been actioned as reactive work and the appropriate job numbers have been linked to them. The work has been completed. State changed to Action scheduled
11/02/2025	Clr Gill asked has the Walnut Tree at St Johns got TPO ?		Hello Charlotte,  I have visited the housing association scheme and appraised all the trees to see whether they warrant a TPO. Whilst on site I met the scheme warden, who assured me that they had no plans for further tree felling at this time. The black walnut tree had been recently pruned, and in my opinion a recent job has been done.  The felled sycamore tree (it might actually have been a Norway maple) was not protected so no notice or permission was required to be submitted or obtained beforehand.  I have not yet had opportunity to analyse the findings of my site visit and decide whether a TPO is to be made and if so, on which trees. Our Tree Team Technicians will prepare the necessary documents and plans and relevant parties will be informed as and when a TPO is made.  I hope this is sufficient to update your committee for the time being.  Many thanks, Martin	CA has emailed SC Customer First to get a copy of the programme of upcoming maintenance  Highway Maintenance customerfirst@shropshire.gov.uk 0345 678 9006
11/02/2025	Busy Bodies Nursery and Friars walk		Friars Walk behind Busy Bodies Nursery trees have been cut and there are loose high level branches left on site, which could dislodge and cause harm, and smaller cuttings have been left on the ground and could become trip hazards	Update received and included TPO in report submitted for 08/04/2025 REP  Good morning,  I have been advised that the work to the trees on Friars Walk was not undertaken on behalf of the Council. The Council's contractor has been on site yesterday and today to clear the debris from the footpath. They have been unable to access the branches to remove them but as they are not believed to be dangerous they have been left. This job will not be closed as completed.  Best wishes,  Lesley Keay Administration Officer Highway Maintenance customerfirst@shropshire.gov.uk
11/02/2025	8 King Street	Enforcement Officer appointed by SC 20/02/2025	Further to your recent enquiry to the council, officers have investigated the matter and it has been established that the works identified in your enquiry amount to the following: Historic Environment have liaised with the owner and rectified the issue. The Council now consider the matter closed. Thank you for your assistance, if you require further information please contact the Council quoting the case reference and location address in this correspondence. 28/02/25	Apologies, this email should say that the work will now be closed as completed.  Best wishes,  Highway Maintenance customerfirst@shropshire.gov.uk 0345 678 9006

signage changed

**Item 14**

**PAVEMENT LICENCE CONSULTATION**

**HARP LANE DELI**



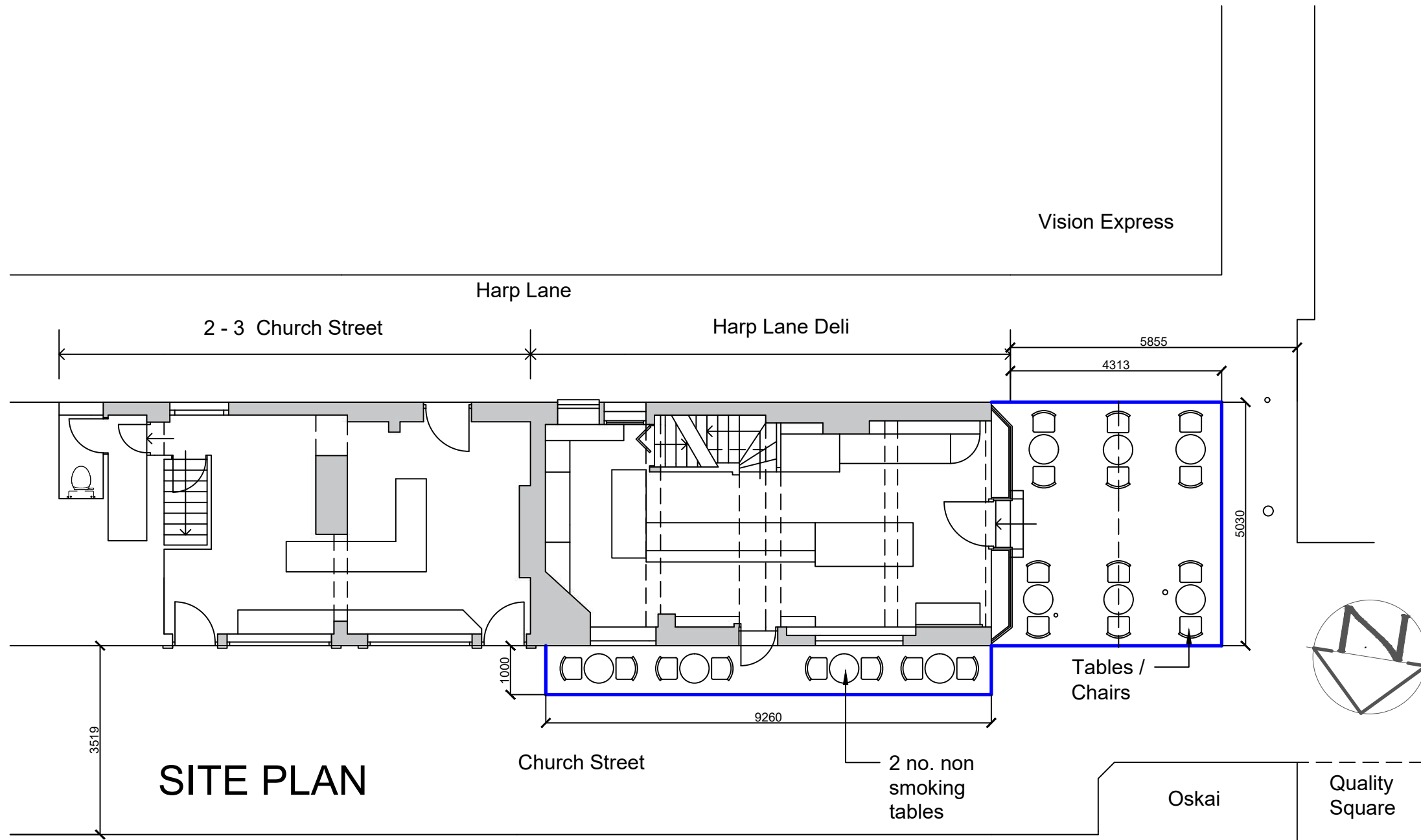

**SITE PLAN**

**NOTES:**  
 This drawing is copyright and may not be reproduced either in part or in full without the prior written permission from Consulting Surveyors. All scale dimensions taken from this drawing are to be verified on site.  
 Materials and workmanship are to comply in all respects with current British Standard code of practice and Building Regulations.  
 The contractor is to check and verify all building and site dimensions, levels and sewer invert levels at connection points prior to commencement of works.  
**IF IN DOUBT ASK. DO NOT SCALE.** This drawing must be read in conjunction with all other Architectural, Structural, Civil and Engineering drawings and specifications

Rev	Date	Details Of Issue	Initials

Issue

**SIMON ANGELL**  
 Architectural and Planning Consultant  
 Orchard Cottage  
 Ashford Carbonell  
 Shropshire  
 SY8 4BX  
 Telephone : 01584831424  
 Mobile : 07855864403

Client **Mr E Sinclair**

Project **Proposed outdoor catering facilities at Harp Lane Deli Ludlow SY8 1AP**

Title **PROPOSED**

Drawn <b>SA</b>	Checked:	Date: <b>March 24</b>	Scale (at A3) <b>1:100</b>
--------------------	----------	--------------------------	-------------------------------

Dwg no. <b>634/24/3</b>	Project no.	Revision No.
----------------------------	-------------	--------------

**Item 15**

**PAVEMENT LICENCE CONSULTATION**  
**WHEATSHEAF**

WHEATTSHEF PUBLIC HOUSE

BENCH  
1

BENCH  
2

BENCH  
3

1.5m

6.6m

ST JOHNS ST

PEDESTRIANISED ST

LOWER BROAD ST

CAR PARKING

DWELLING

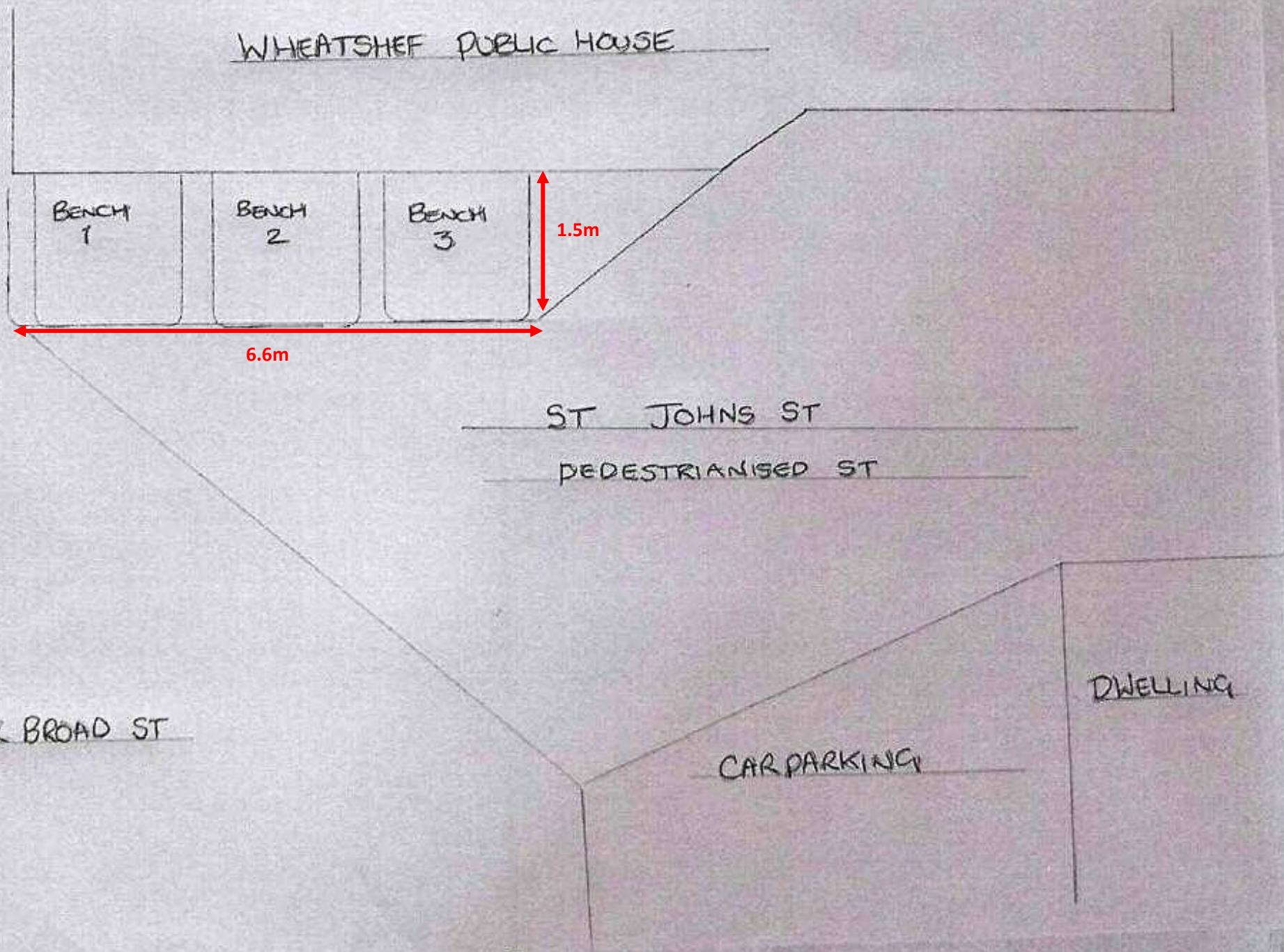

Item 16

**NOTICE AND PROVISIONAL ORDER FOR THE**  
**SHROPSHIRE COUNCIL (LAND OFF ST**  
**JOHN'S LANE**

Ms Gina Wilding  
Ludlow Town Council  
The Guildhall  
Mill Street  
Ludlow  
Shropshire  
SY8 1AZ

Date: 26th March 2025

Our Ref: SC/00533/25

Your Ref:

Dear Ms Gina Wilding

**SHROPSHIRE COUNCIL**

**Shropshire Council (Land off St John's Lane and Old Street, Ludlow) TPO 2025  
TREE PRESERVATION ORDER: SC/00533/25**

In accordance with the Town and Country Planning Act 1990, I enclose for your information a copy of the above-named Order and Notice, which has been made by the Council.

If you wish to make any representations about this Order you are invited to send written comments, in accordance with the requirements specified in the Notice, to **Planning Services – Tree Team, Shropshire Council, PO Box 4826, Shrewsbury, SY1 9LJ.**

Yours sincerely

*Martin Sutton*

**Martin Sutton**  
**County Arboriculturalist**

trees@shropshire.gov.uk  
01743 25 3333

Enc





## IMPORTANT

### THIS COMMUNICATION MAY AFFECT YOUR PROPERTY

#### Town and Country Planning Act 1990

#### Town and Country Planning (Tree Preservation) (England) Regulations 2012

#### Tree Preservation Order: Shropshire Council (Land off St John's Lane and Old Street, Ludlow) TPO 2025

**THIS IS A FORMAL NOTICE to let you know that on the 26th March 2025 we made the above tree preservation order.** A copy of the order is enclosed. In simple terms, no one is allowed to cut down, top or lop without our permission any of the trees described in the 1<sup>st</sup> Schedule of the order and shown on the map. Guidance about tree preservation orders can be found at [www.gov.uk/guidance/tree-preservation-orders-and-trees-in-conservation-areas](http://www.gov.uk/guidance/tree-preservation-orders-and-trees-in-conservation-areas). The reason for making the order is to preserve the amenity and character of the area by protecting these trees that make a significant contribution to these attributes. The order came into force, on a temporary basis, on the **26th March 2025** and will remain in force for six months. During this time, we will decide whether the order should be confirmed and thereby given a permanent status. People affected by the order have a right to object or make comments on any of the trees covered before we decide whether the order should be permanent.

If you would like to make any objections, offer support or other comments, please make sure we receive them in writing by the **26th April 2025**. Your comments must meet regulation 6 of the Town and Country Planning (Tree Preservation) (England) Regulations 2012 (see below). Please send your comments to: **Planning Services – Tree Team, Shropshire Council, PO Box 4826, Shrewsbury, SY1 9LJ**. We will carefully consider all objections and comments before deciding whether to make the order permanent. We will write to you again when we have made our decision. In the meantime, if you would like any more information or have any questions about this letter, please contact **Martin Sutton, Planning Services – Tree Team, Shropshire Council, PO Box 4826, Shrewsbury, SY1 9LJ**.

**Dated: 26th March 2025**

**Signed:**

On behalf of: Andy Wilde – Assistant Director for Infrastructure  
Shropshire Council, Shirehall, Abbey Foregate, Shrewsbury, Shropshire SY2 6ND

By: Martin Sutton, County Arboriculturalist, Authorised Officer

#### **COPY OF REGULATION 6 OF THE TOWN AND COUNTRY PLANNING (TREE PRESERVATION) (ENGLAND) REGULATIONS 2012**

##### Objections and representations

6(1) Subject to paragraph (2), objections and representations –

- (a) shall be made in writing and –
  - (i) delivered to the authority not later than the date specified by them under regulation 5(2)(c); or
  - (ii) sent to the authority in a properly addressed and pre-paid letter posted at such time that, in the ordinary course of post, it would be delivered to them not later than that date;
- (b) shall specify the particular trees, groups of trees or woodlands (as the case may be) in respect of which the objections or representations are made; and
- (c) in the case of an objection, shall state the reasons for the objection.

(2) The authority may treat as duly made objections and representations which do not comply with the requirements of paragraph (1) if, in the particular case, they are satisfied that compliance with those requirements could not reasonably have been expected.



**Shropshire Council**

**TOWN AND COUNTRY PLANNING ACT 1990**

THE TOWN AND COUNTRY PLANNING (TREE PRESERVATION) (ENGLAND)  
REGULATIONS 2012

**TREE PRESERVATION ORDER**

**relating to**

**Shropshire Council (Land off St John's Lane and Old Street, Ludlow) TPO 2025**

**Order Number: SC/00533/25**

**Town and Country Planning Act 1990**  
**Shropshire Council (Land off St John's Lane and Old Street, Ludlow) TPO 2025**

**The Shropshire Council, in exercise of the powers conferred on them by section 198 of the Town and Country Planning Act 1990 make the following Order—**

**Citation**

1. This Order may be cited as the Shropshire Council (Land off St John's Lane and Old Street, Ludlow) TPO 2025.

**Interpretation**

2. (1) In this Order “the authority” means the Shropshire Council

(2) In this Order any reference to a numbered section is a reference to the section so numbered in the Town and Country Planning Act 1990 and any reference to a numbered regulation is a reference to the regulation so numbered in the Town and Country Planning (Tree Preservation) (England) Regulations 2012.

**Effect**

3. (1) Subject to article 4, this Order takes effect provisionally on the date on which it is made

(2) Without prejudice to subsection (7) of section 198 (power to make tree preservation orders) or subsection (1) of section 200 (tree preservation orders: Forestry Commissioners), and subject to the exceptions in regulation 14, no person shall

(a) cut down, top, lop, uproot, wilfully damage or wilfully destroy; or

(b) cause or permit the cutting down, topping, lopping, uprooting, wilful damage or willful destruction of,

any tree specified in the Schedule to this Order except with the written consent of the authority in accordance with regulations 16 and 17, or of the Secretary of State in accordance with regulation 23, and, where such consent is given subject to conditions, in accordance with those conditions.

**Application to trees to be planted pursuant to a condition**

4. In relation to any tree identified in the first column of the Schedule by the letter “C”, being a tree to be planted pursuant to a condition imposed under paragraph (a) of section 197 (planning permission to include appropriate provision for preservation and planting of trees), this Order takes effect as from the time when the tree is planted.



**THE COMMON SEAL of  
The SHROPSHIRE COUNCIL**

**Dated this 26th March 2025**

Signed:

A handwritten signature in black ink, appearing to read 'A. Wilde', written over a faint, circular embossed seal impression.

Signed on behalf of: Andy Wilde, Assistant Director for Infrastructure  
Shropshire Council, Tree Team, Shirehall, Abbey Foregate, Shrewsbury, Shropshire SY2  
6ND

By Authorised Officer: Martin Sutton, County Arboriculturalist



© Crown copyright 2025 OS AC0000808715



**Shropshire Council (Land off St John's Lane and Old Street, Ludlow) TPO 2025**

Scale : 1:1,000

## SCHEDULE 1

### SPECIFICATION OF TREES

#### *TREES SPECIFIED INDIVIDUALLY* (encircled in black on map)

<b>Map ref</b>	<b>Description;</b>	<b>Situation</b>
T1	Silver Birch	On land at grid ref Easting:35131, Northing:27441.

<b>Map ref</b>	<b>Description;</b>	<b>Situation</b>
T2	Silver Birch	On land at grid ref Easting:35132, Northing:27440.

<b>Map ref</b>	<b>Description;</b>	<b>Situation</b>
T3	Walnut	On land at grid ref Easting:35135, Northing:27434.

<b>Map ref</b>	<b>Description;</b>	<b>Situation</b>
T4	Common Beech	On land at grid ref Easting:35135, Northing:27437.

<b>Map ref</b>	<b>Description;</b>	<b>Situation</b>
T5	Norway Maple	On land at grid ref Easting:35138, Northing:27432.

<b>Map ref</b>	<b>Description;</b>	<b>Situation</b>
T6	Norway Maple	On land at grid ref Easting:35137, Northing:27429.

<b>Map ref</b>	<b>Description;</b>	<b>Situation</b>
T7	Silver Birch	On land at grid ref Easting:35142, Northing:27427.

#### *TREES SPECIFIED BY REFERENCE TO AN AREA* (NONE)

#### *GROUPS OF TREES* (NONE)

#### *WOODLANDS* (NONE)

**Item 17**

**PLANNING AND INFRASTRUCTURE BILL**

# Planning and Infrastructure Bill Introduced to Parliament

12 March 2025

The government has just introduced the Planning and Infrastructure Bill to Parliament. The bill, if enacted, would introduce ‘seismic’ changes to the planning and development system, particularly aimed at speeding up and streamlining planning decision-making.

The key proposals of interest to the sector are:

- The system of strategic planning across England would be reintroduced. This would require combined authorities and combined county authorities, both mayoral and non-mayoral, to produce a spatial development strategy (SDS). Where combined authorities do not exist, county and unitary councils will be given the power to prepare SDS. The SDS would not be able to allocate sites but would be able to identify broad areas of growth and set out a housing target figure for the area.
- A more streamlined process for compulsory purchase orders (CPO) will be introduced, including extending the existing power to remove ‘hope value’ (value attributed to the prospect of planning permission) to town, parish and community councils where they are using CPO powers to deliver affordable or social housing provision.
- A national scheme of delegation would set out which planning applications should be dealt with by planning officers and which should go to local authority planning committees. This is aimed at reducing the number of non-strategic and controversial planning applications that go to local authority planning committees.
- The government intends to issue guidance setting out the size and composition of local authority planning committees, and members of such committees will be expected to undertake planning training before they can make planning decisions.
- Local authorities would be able to set their own planning fees, and the resulting fees could be ring fenced for the delivery of planning applications.
- The National Significant Infrastructure Projects (NSIPs) process to deliver nationally significant infrastructure, such as green energy projects, roads or railway lines, will be streamlined to make it faster.
- There will be greater prioritisation of green energy projects, including making it easier to install electric vehicle charging points.
- Further measures are aimed at boosting new or upgraded electricity infrastructure such as pylons. People living close to such projects/pylons would receive financial benefits/payments.
- The government would set up a Nature Restoration Fund, which will enable developers to meet their environmental obligations by paying into a national fund rather than on a site-by-site basis.

Please note that while most of the proposals would apply to England and Wales, some are England only.

Read the full bill and associated briefings [here](#).

